

Digital Color Printer
(M095/M096-EU/AA)
Parts Catalog

Parts change information sample

 **Add**

 **Update**

 **Delete**

Model	Product Code	PC Style
Digital Color Printer	M095/M096	3D
Paper Feed unit Type1010	G849	Traditional

Unit All



U001
EXTERIOR



U002
OPERATION



U003
LASER UNIT



U004
PAPER TRAY



U005
ITB CLEANING

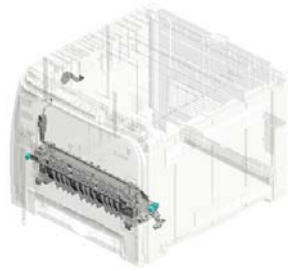

U006
PAPER TRANSPORT

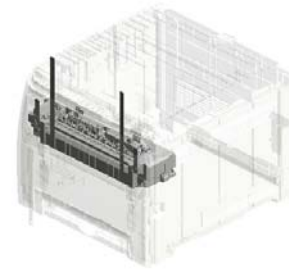

U007
FUSING



U008
PAPER EXIT

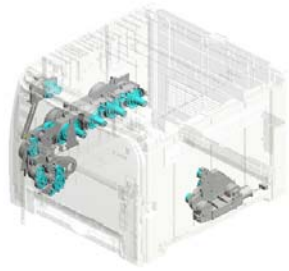

U009
MAIN DRIVE

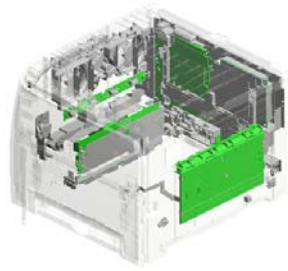

U010
ELECTRICAL

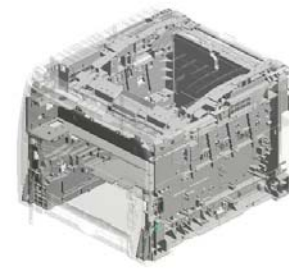

U011
MAIN FRAME

U001.EXTERIOR

U001_S001
M0960042
COVER:LEFT:ASS'Y

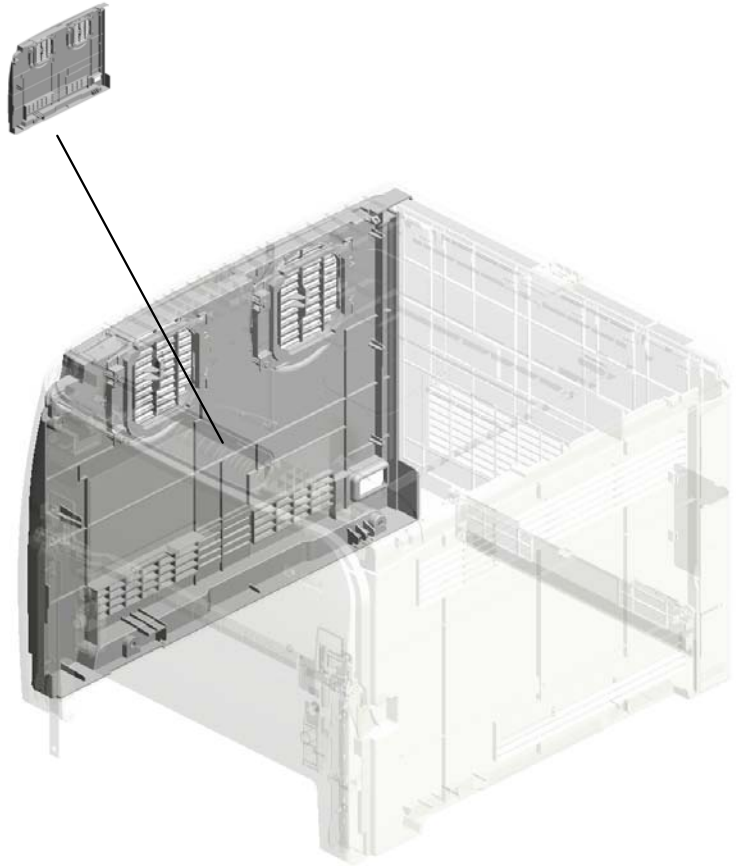

U001	U002	U003	U004	U005	U006	U007	U008	U009	U010	U011
------	------	------	------	------	------	------	------	------	------	------

U001 EXTERIOR

7.G1661260
EXTEND TRAY

16.G1661311
SEAL - 5X15X222M

14.G1661300
COVER:UPPER

13.G1661283
FRONT END FENCE
E - EXIT

12.G1661282
REAR END FENCE
- EXIT



10.G1661269
STOPPER BAND

1.03603010N
SCREW:M3X10

6.11029156
CONNECTOR

8.G1661261
INNER COVER - EX
IT

17.G1661312
SEAL - 7X25X176M

18.G1661313
SEAL - 3X8X411MM

2.04503010N
(x13)
TAPPING SCREW -
M3X10

5.04543008Q
(x3)
TAPPING SCREW:3
X8

3.04504010N
(x2)
TAPPING SCREW:
M4X10

20.G1661318
SHEET - CASSETT
E COVER

11.G1661281
BASE - EXIT END F
ENCE

19.G1661317
(x2)
SEAL - 4X30X30MM

4.04524010N
(x5)
BINDING SELF-TAP
PING SCREW:4X10

15.G1661308
INTERFACE COVE
R

9.G1661262
CASSETTE COVER

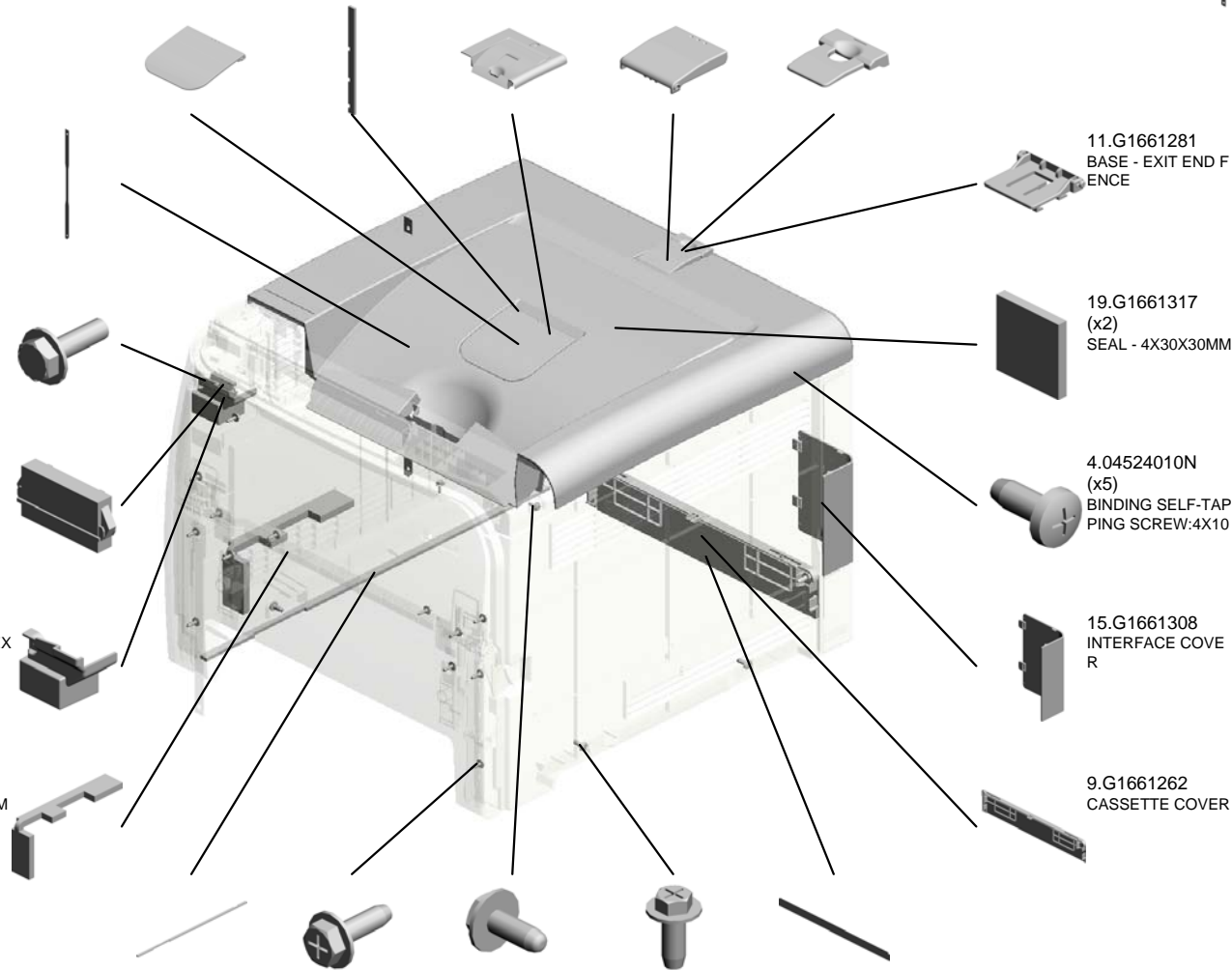

U001 EXTERIOR



- 21.G1661319 (x2) SEAL:COVER:LEFT :7
- 29.G1663908 LOCK LEVER ARM
- 36.G1663933 STOPPER:FEELER: PAPER FEED SENSOR
- 33.G1663925 TORSION SPRING - FEELER
- 22.G1661320 SEAL:COVER:LEFT :6

39.G1663970
LEFT HOOK

27.G1663906
LEFT LOCK LEVER

31.G1663910
GROUND WIRE

25.G1663904
LEFT FRAME - FRONT COVER

34.G1663927
STOPER BAND

28.G1663907
LOCK GUIDE

37.G1663957 (x2)
WASHER - 0.8X10.8MM

38.G1663962 (x2)
COMPRESSION SPRING RING HOLDER

30.G1663909
TENSION SPRING

24.G1663903
RIGHT FRAME - FRONT COVER

32.G1663921 (x2)
GUIDE PLATE SPRING - MIDDLE

23.G1661333
COVER:RIGHT:EU

40.G1663971
RIGHT FHOOK

26.G1663905
RIGHT LOCK LEVER

35.G1663928
BRAKE RACK - FRONT COVER

U001 EXTERIOR

57.M0963923 GUIDE PLATE:EXIT:MIDDLE
 59.M0963926 ROLLER:GUIDE:EXIT:MIDDLE
 53.M0961277 COVER:PAPER EXIT SUB-UNIT
 44.G1665705 SHIELDING PLATE



56.M0963912 HOLDER:GUIDE PLATE:REVERSE

42.G1664464 DECAL:HIGHTEMPERATURE



55.M0963902 COVER:FRONT

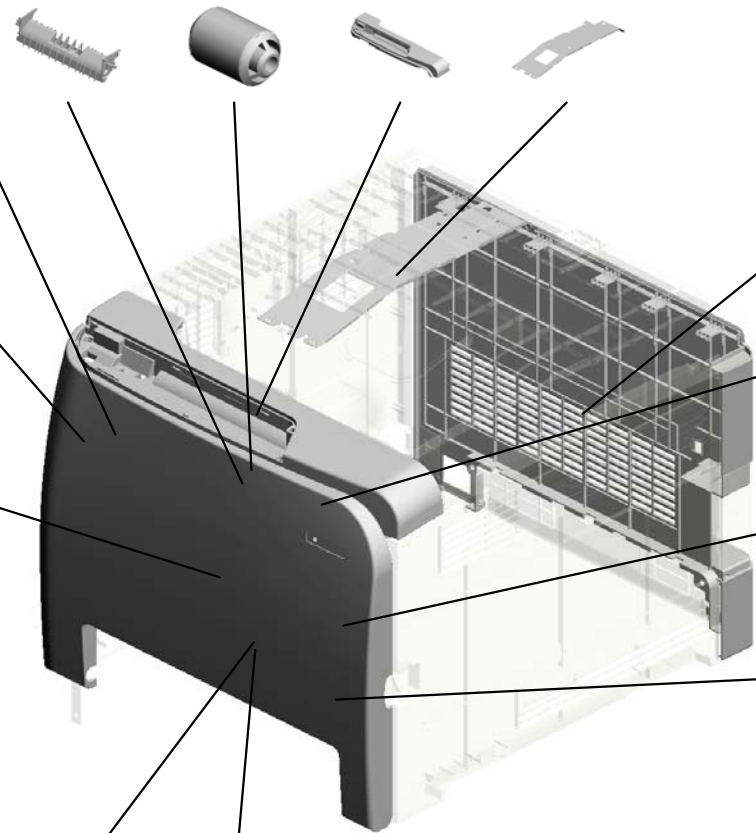

54.M0961304 COVER:REAR:EU



58.M0963924 FEELER:PAPER FEED SENSOR



41.G1663972 (x2) COMPRESSION SPRING - GRIP



45.M0353974 (x2) COMPRESSION SPRING:HOUSING:TRANSPORT

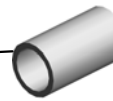

43.G1664606 (x2) DUPLEX ROLLER



51.M0754607 (x2) SPRING:PRESSURE:DUPLEX



U001_S001
COVER:LEFT:ASS'Y

2.04503010N (x4)
TAPPING SCREW - M3X10

48.M0751253 (x2)
LOUVER

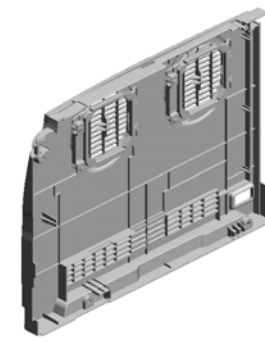

52.M0960042
COVER:LEFT:ASS'Y

47.M0751252 (x2)
SEAL:STOPPER:LOUVER



49.M0751308 (x2)
SEAL:GUIDE:LOUVER:UPPER



46.M0751251 (x2)
GUIDE:LOUVER



50.M0751309 (x2)
SEAL:GUIDE:LOUVER:LOWER



U001	U002	U003	U004	U005	U006	U007	U008	U009	U010	U011
------	------	------	------	------	------	------	------	------	------	------

U002.OPERATION

U002_S001
M0961400
OPERATION PANEL:M096:EU
:ASS'Y

U002_S002
M0951400
OPERATION PANEL:M095:EU
: ASS'Y

U002_S003
M0951403
OPERATION PANEL:M095:T
WN:ASS'Y

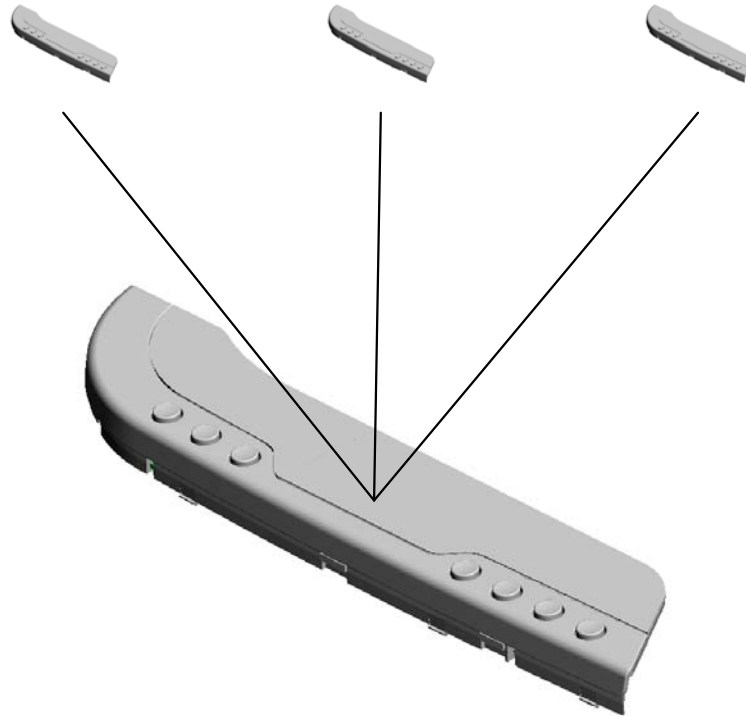

U001	U002	U003	U004	U005	U006	U007	U008	U009	U010	U011
------	-------------	------	------	------	------	------	------	------	------	------

U002 OPERATION

1.04503010N
(x2)
TAPPING SCREW -
M3X10

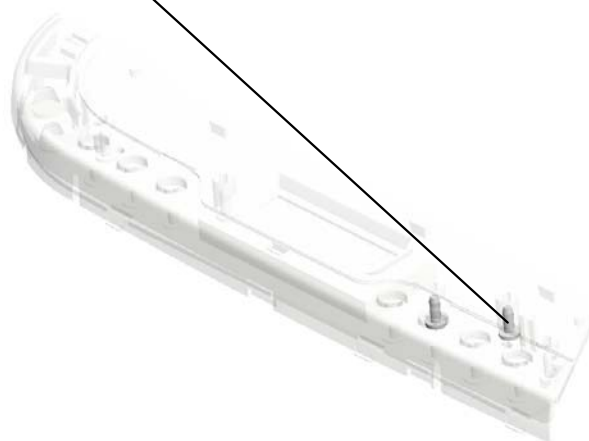

U002_S001
OPERATION PANEL:M096:EU:ASS'Y

5.M0961466
PCB:PERSEUS-P2:
OPU



4.M0961400
OPERATION PANE
L:M096:EU:ASS'Y

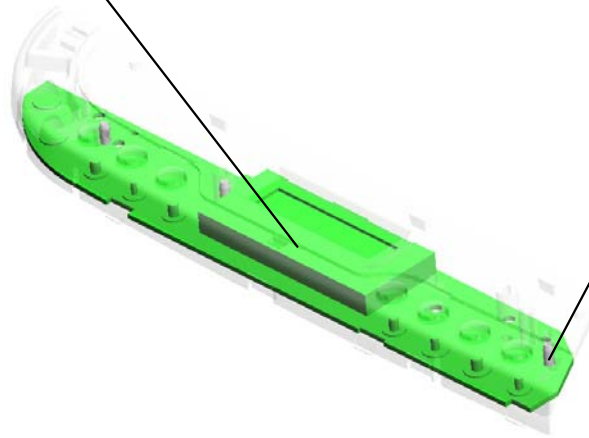

1.04503010N
(x3)
TAPPING SCREW -
M3X10

U001	U002	U003	U004	U005	U006	U007	U008	U009	U010	U011
------	-------------	------	------	------	------	------	------	------	------	------

U002_S002
OPERATION PANEL:M095:EU: ASS'Y

5.M0961466
PCB:PERSEUS-P2:
OPU



2.M0951400
OPERATION PANE
L:M095:EU: ASS'Y

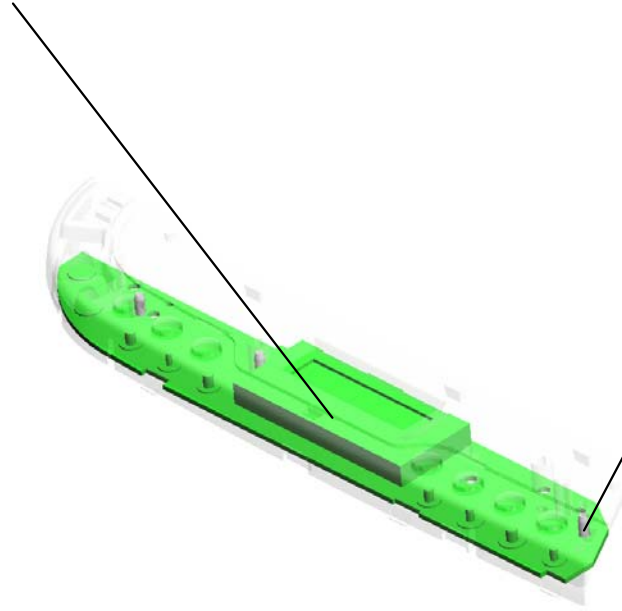
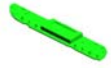

1.04503010N
(x3)
TAPPING SCREW -
M3X10

U001	U002	U003	U004	U005	U006	U007	U008	U009	U010	U011
------	-------------	------	------	------	------	------	------	------	------	------

U002_S003
OPERATION PANEL:M095:TWN:ASS'Y

5.M0961466
PCB:PERSEUS-P2:
OPU



3.M0951403
OPERATION PANE
L:M095:TWN:ASS'Y

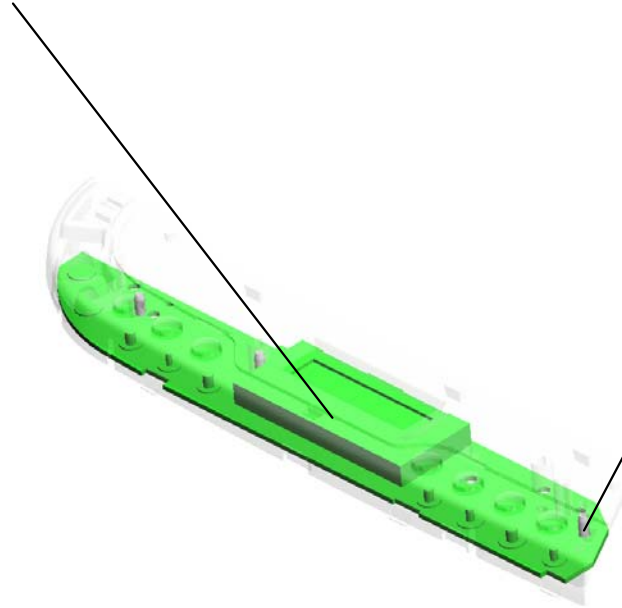

1.04503010N
(x3)
TAPPING SCREW -
M3X10

U001	U002	U003	U004	U005	U006	U007	U008	U009	U010	U011
------	-------------	------	------	------	------	------	------	------	------	------

U003.LASER UNIT

U003_S001
M0931851
IMAGING UNIT:ASS'Y

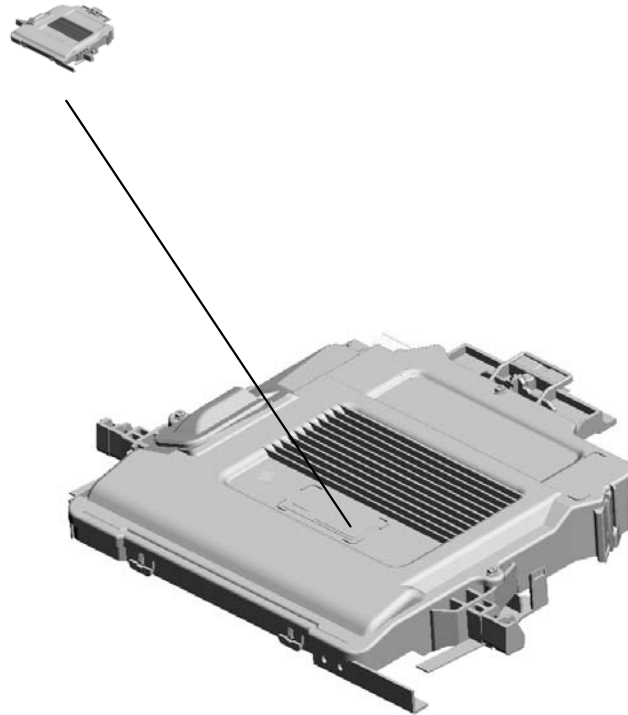

U001	U002	U003	U004	U005	U006	U007	U008	U009	U010	U011
------	------	------	------	------	------	------	------	------	------	------

U003
LASER UNIT



U001	U002	U003	U004	U005	U006	U007	U008	U009	U010	U011
------	------	------	------	------	------	------	------	------	------	------

U003_S001
IMAGING UNIT:ASS'Y

1.04503010N
(x2)
TAPPING SCREW -
M3X10

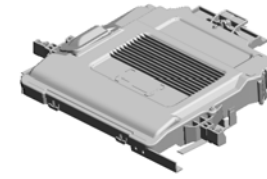

2.M0931851
IMAGING UNIT:ASS
'Y

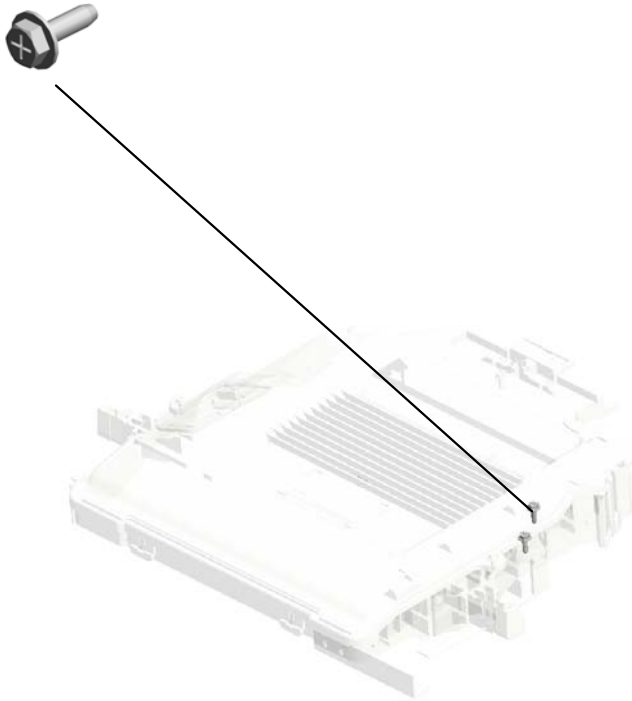

U001	U002	U003	U004	U005	U006	U007	U008	U009	U010	U011
------	------	------	------	------	------	------	------	------	------	------

U004.PAPER TRAY

U004_S001
M0962550
PAPER TRAY:ASSY

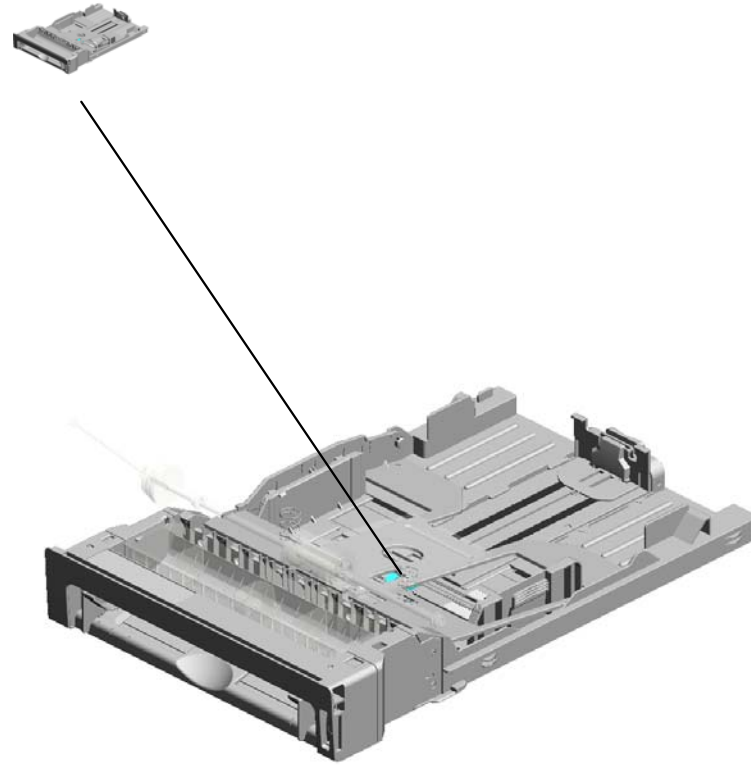

U001	U002	U003	U004	U005	U006	U007	U008	U009	U010	U011
------	------	------	------	------	------	------	------	------	------	------

U004_S001.PAPER TRAY:ASS'Y

U004_S001_S001
M0182562
BASE:ADHESION

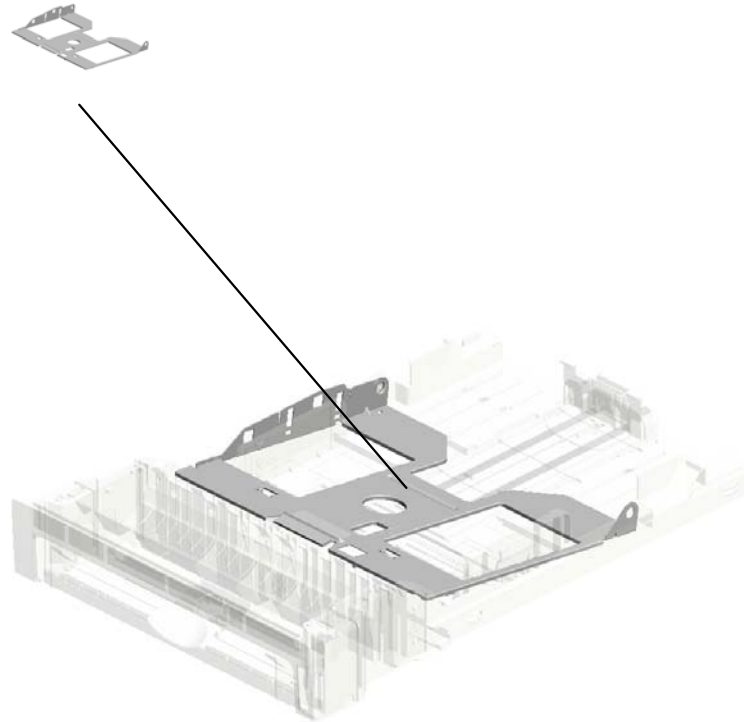

U001	U002	U003	U004	U005	U006	U007	U008	U009	U010	U011
------	------	------	------	------	------	------	------	------	------	------

U004 PAPER TRAY

29.GX201123
MAGNETIC CLUTC
H:0.25N

30.H5213355
C RING - PAPER F
EED ROLLER
201308-02 X/X

38.M1982580
SHAFT:PAPER FEE
D ROLLER:PRESS
FIT
201308-01 X/X

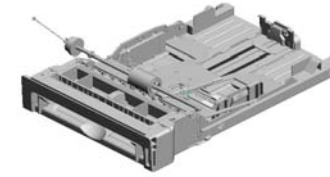

12.G1662554
DUPLEX GUIDE

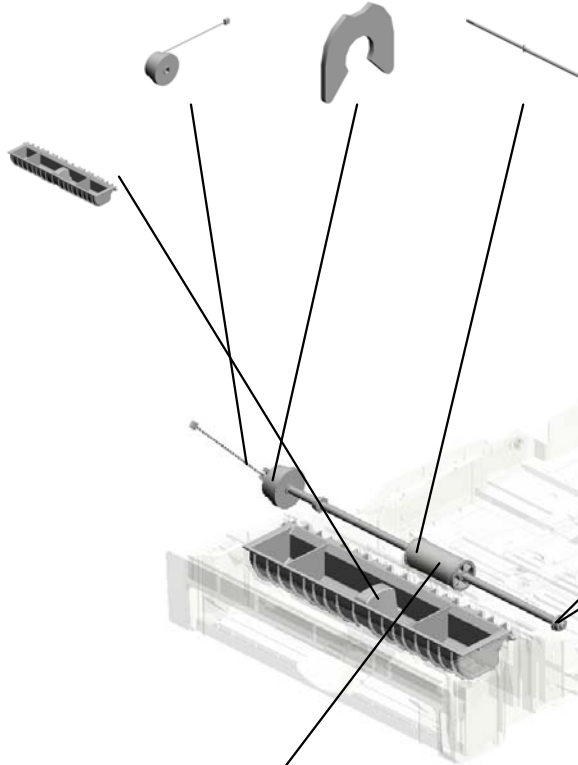

4.8050089
(x2)
RETAINING RING -
M4

6.AA082101
(x2)
BUSHING - 6X10X6

8.AF031061
PAPER FEED ROLL
ER

U001	U002	U003	U004	U005	U006	U007	U008	U009	U010	U011
------	------	------	------	------	------	------	------	------	------	------

U004_S001
PAPER TRAY:ASS'Y

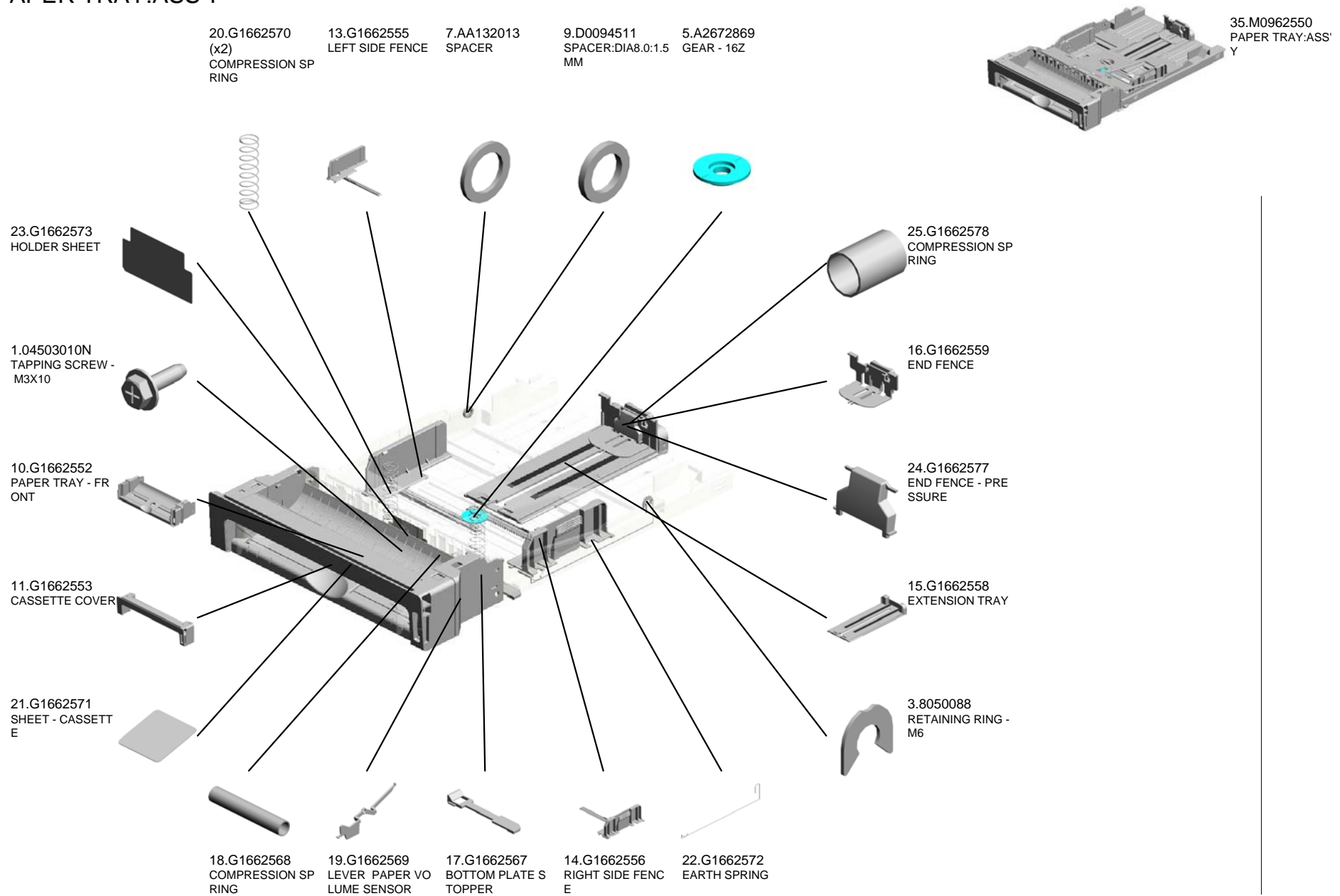

U004_S001
PAPER TRAY:ASS'Y

28.G8003133 27.G1662606 32.M0182608
SIDE FENCE GEAR COMPRESSION SP
RING COVER:BASE



35.M0962550
PAPER TRAY:ASS'
Y

36.M0962560
SIDE FENCE:LEFT:
MANUAL FEED

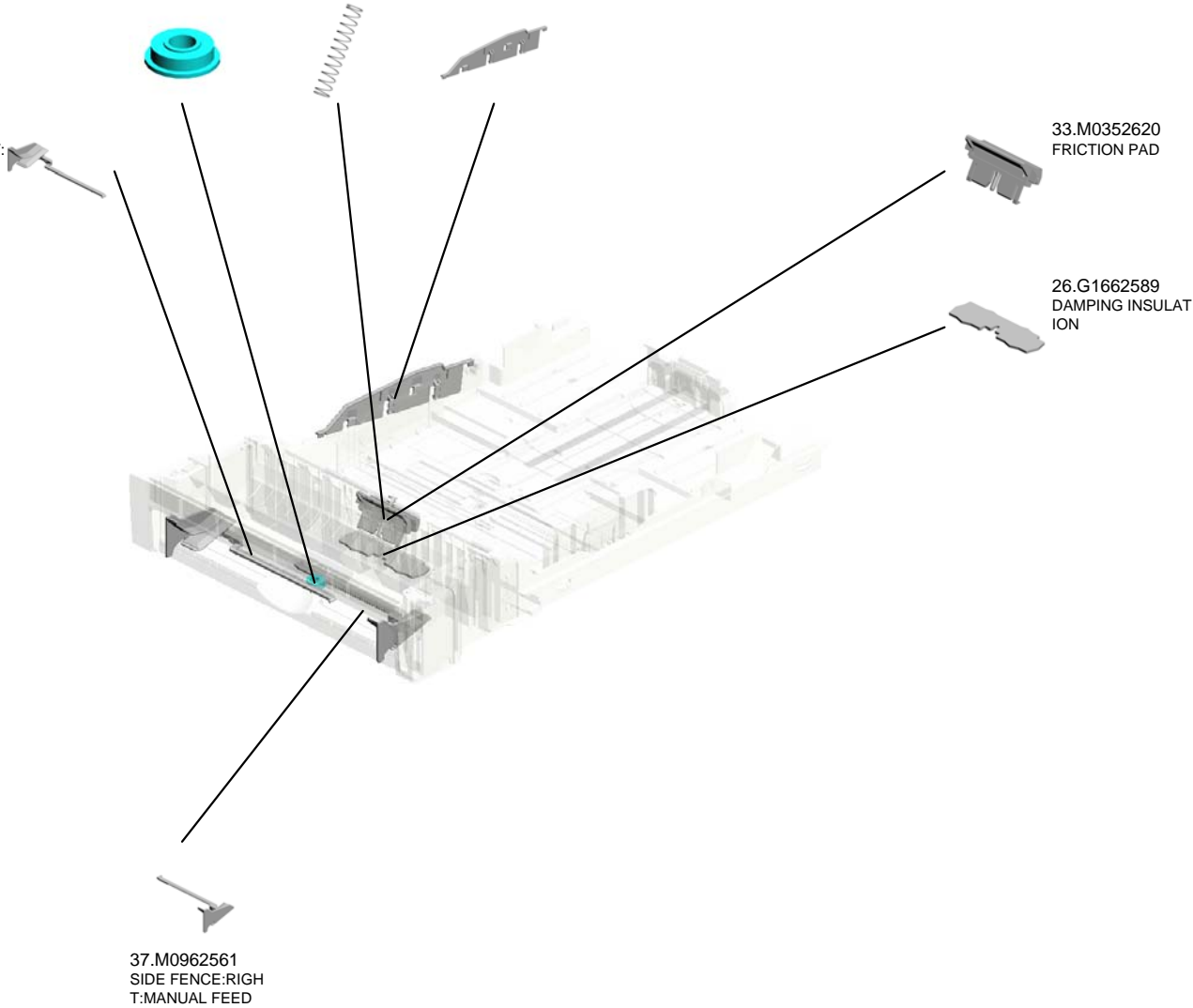

U001	U002	U003	U004	U005	U006	U007	U008	U009	U010	U011
------	------	------	-------------	------	------	------	------	------	------	------

U004_S001_S001
BASE:ADHESION

2.52152713
BOTTOM PLATE P
AD

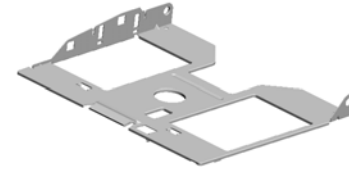

31.M0182562
BASE:ADHESION



U001	U002	U003	U004	U005	U006	U007	U008	U009	U010	U011
------	------	------	-------------	------	------	------	------	------	------	------

U005.ITB CLEANING

U005_S001
M0966000
INTERMEDIATE TRANSFER
SECTION:ASSY

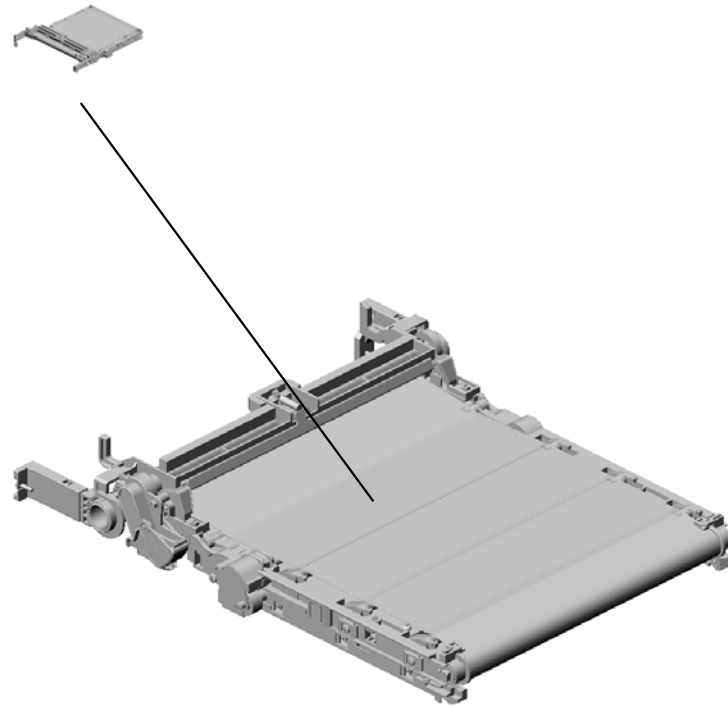

U001	U002	U003	U004	U005	U006	U007	U008	U009	U010	U011
------	------	------	------	------	------	------	------	------	------	------

U005
ITB CLEANING

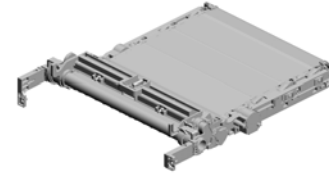

U001	U002	U003	U004	U005	U006	U007	U008	U009	U010	U011
------	------	------	------	------	------	------	------	------	------	------

U005_S001

INTERMEDIATE TRANSFER SECTION:ASS'Y

6.G1666194
RIGHT HOLDER - T
TRANSFER BELT UN
IT

3.G1666026
(x2)
BUSHING - 19MM

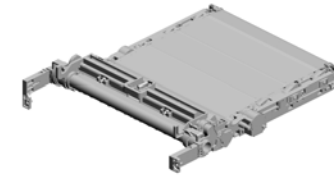

9.M0966000
INTERMEDIATE TR
ANSFER SECTION:
ASS'Y

7.G1666196
RIGHT SLIDER - TR
ANSFER BELT UNI
T

4.G1666099
(x2)
COMPRESSION SP
RING

5.G1666193
LEFT HOLDER - TR
ANSFER BELT UNI
T

2.07200040E
(x2)
RETAINING RING -
M4

1.04503010N
(x5)
TAPPING SCREW -
M3X10

8.G1666197
LEFT SLIDER - TRA
NSFER BELT UNIT

U001	U002	U003	U004	U005	U006	U007	U008	U009	U010	U011
------	------	------	------	-------------	------	------	------	------	------	------

U006.PAPER TRANSPORT

U006_S001
M0963800
HOUSING:TRANSPORT SUB-
UNIT:ASS'Y

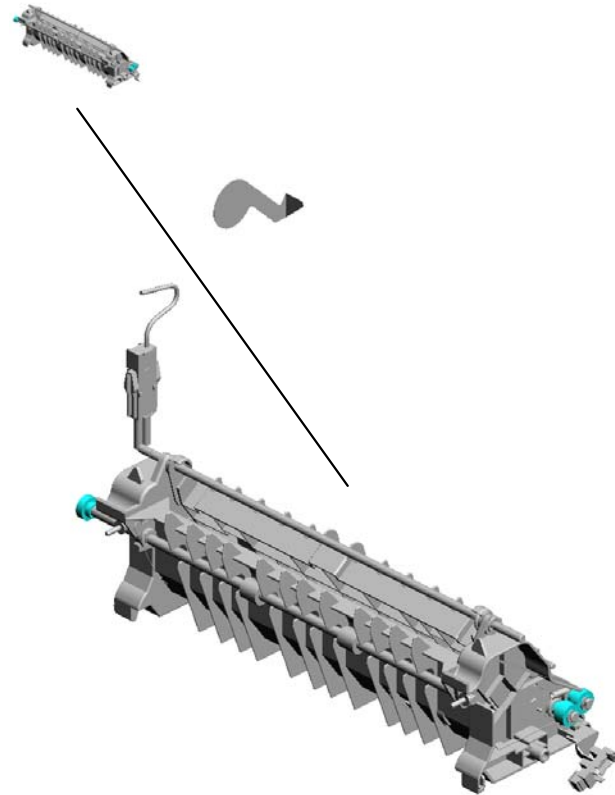

U001	U002	U003	U004	U005	U006	U007	U008	U009	U010	U011
------	------	------	------	------	------	------	------	------	------	------

U006_S001.HOUSING:TRANSPORT SUB-UNIT:ASS'Y

U006_S001_S001
M0966202
TRANSFER ROLLER:SUB-AS
S'Y

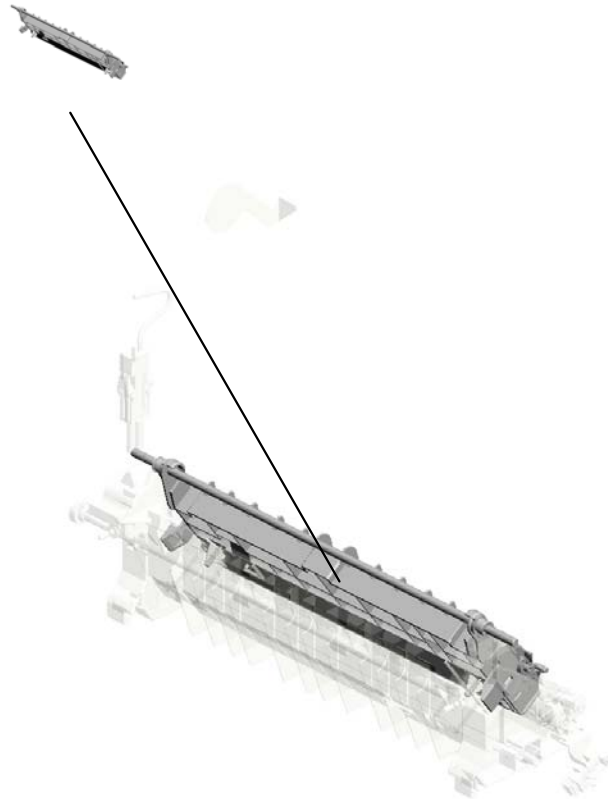

U001	U002	U003	U004	U005	U006	U007	U008	U009	U010	U011
------	------	------	------	------	------	------	------	------	------	------

U006
PAPER TRANSPORT

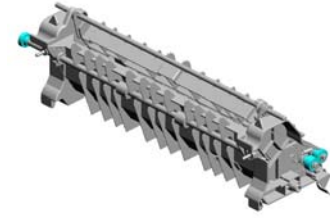

U001	U002	U003	U004	U005	U006	U007	U008	U009	U010	U011
------	------	------	------	------	------	------	------	------	------	------

U006_S001
HOUSING:TRANSPORT SUB-UNIT:ASS'Y



25.M0963800
HOUSING:TRANSP
ORT SUB-UNIT:AS
SY

16.G1663983 SPACER:GROUND
PLATE:TRANSPOR
T
10.G1663865 (x2)
GEAR - 14Z
2.07200040E (x5)
RETAINING RING -
M4
19.GA082015 (x6)
PLAIN SHAFT BEA
RING:DIA6:DIA9:7
8.G1663862 (x2)
GUIDE SHEET - RE
GISTRATION

20.GB011133
GEAR - 15Z

1.04503010N
(x2)
TAPPING SCREW -
M3X10

15.G1663968
ELECTRODE PLAT
E - CONTACT POIN
T

18.G1663998
GROUND WIRE- D
UPLEX

14.G1663967
ELECTRODE PLAT
E - LINK

17.G1663997
GROUND WIRE:TR
ANSFER/SEPARATI
ON

9.G1663863
REGISTRATION G
UIDE

7.G1663860
TORSION SPRING

3.8050089
(x2)
RETAINING RING -
M4

12.G1663961
(x2)
COMPRESSION SP
RING

4.G1663852
REGISTRATION R
OLLER - DRIVEN

6.G1663859
REGISTRATION SE
NSOR FEELER

5.G1663855
(x2)
TENSION SPRING

11.G1663867
DRIVE GEAR - 14Z

13.G1663965
GROUND WIRE

U006_S001
HOUSING:TRANSPORT SUB-UNIT:ASS'Y

22.GF020060 21.GF020000
TRANSPORT ROLL REGISTRATION R
ER:DUPLEX OLLER - DRIVE



25.M0963800
HOUSING:TRANSP
ORT SUB-UNIT:AS
SY

28.M0963989
RESISTOR:TRANS
FER/SEPARATION

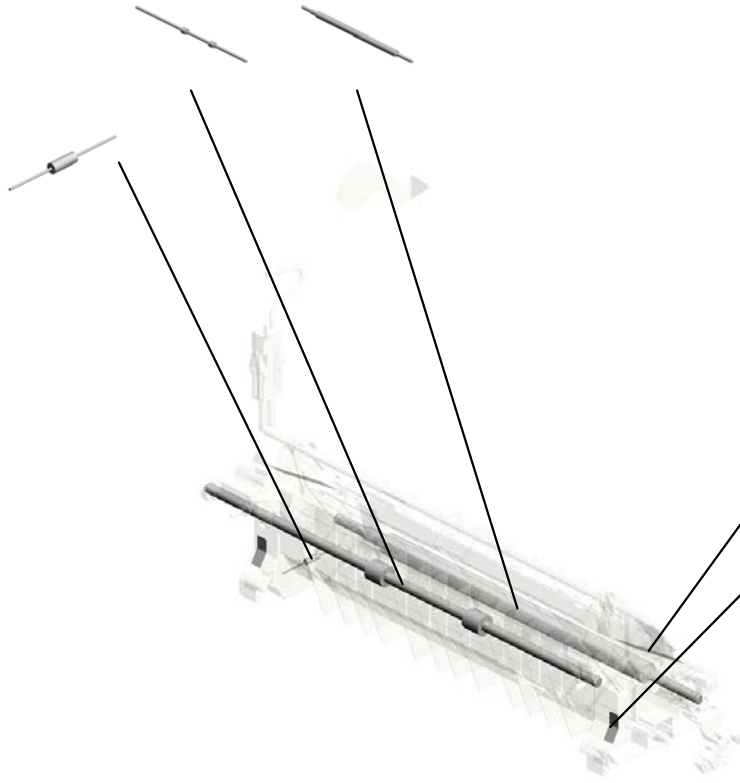

26.M0963987
(x2)
Decal:Grip:Housing

27.M0963988
(x2)
Decal:Insert Sub-uni
t:Transport Unit

U001	U002	U003	U004	U005	U006	U007	U008	U009	U010	U011
------	------	------	------	------	------	------	------	------	------	------

U006_S001_S001
TRANSFER ROLLER:SUB-ASS'Y

2.07200040E (x2)
RETAINING RING - M4

1.04503010N (x2)
TAPPING SCREW - M3X10

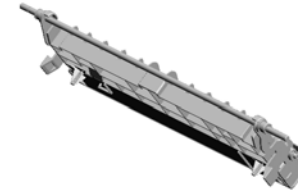

29.M0966202
[A]
TRANSFER ROLLE
R:SUB-ASS'Y
201309-01 O/O

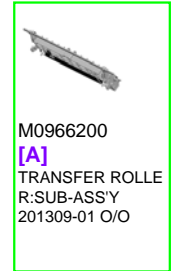

M0966200
[A]
TRANSFER ROLLE
R:SUB-ASS'Y
201309-01 O/O

U001	U002	U003	U004	U005	U006	U007	U008	U009	U010	U011
------	------	------	------	------	-------------	------	------	------	------	------

U007.FUSING

U007_S001
M0964027
FUSING UNIT - 230V

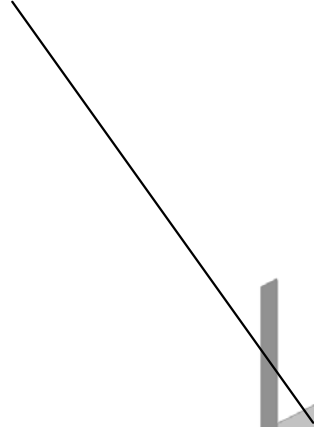

U007_S002
M0964019
FUSING UNIT - TWN 110V

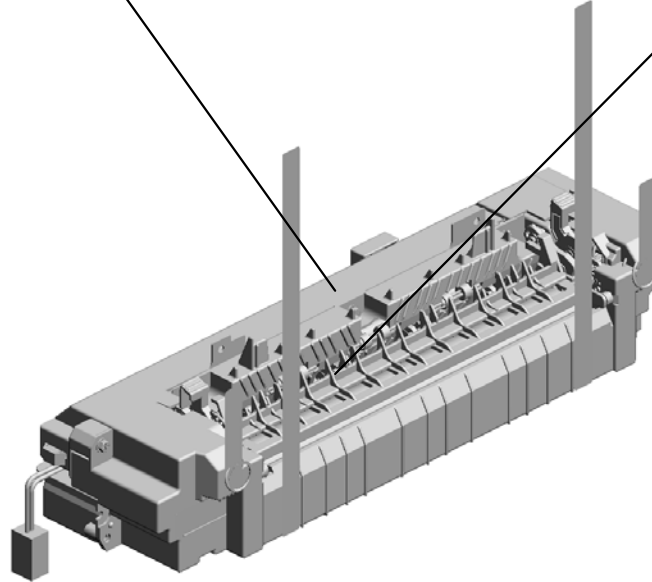
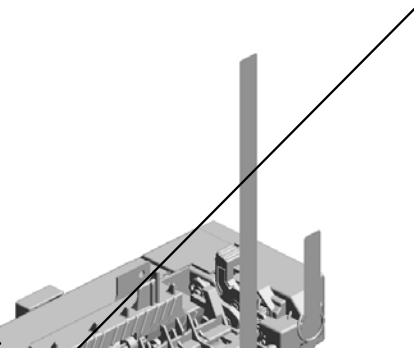

U001	U002	U003	U004	U005	U006	U007	U008	U009	U010	U011
------	------	------	------	------	------	------	------	------	------	------

U007
FUSING

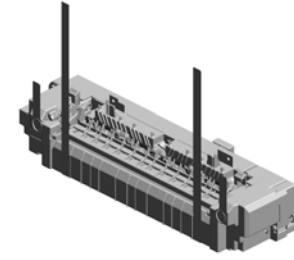

U001	U002	U003	U004	U005	U006	U007	U008	U009	U010	U011
------	------	------	------	------	------	------	------	------	------	------

U007_S001 FUSING UNIT - 230V

7.GX450006
HEATER:110V:1000
W

8.GX450009
HEATER:230V:1000
W

21.M0964111
COVER:FUSING

13.M0964112
PRESSURE COVE
R

5.AA143520
SHOULDER SCRE
W - M3

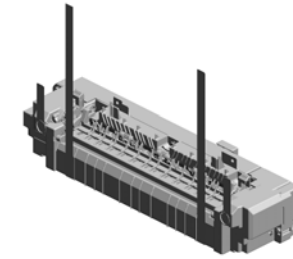

18.M0964027
FUSING UNIT - 230
V

16.M0964116
TORSION SPRING:
GUIDE PLATE:PRE
SSURE:LEFT

3.07200040E
RETAINING RING -
M4

10.M0964085
HOLDER:FUSING E
NTRANCE GUIDE P
LATE:LEFT

6.G1664310
DECAL:WARNING (H
IGH TEMPERATU
RE):1:CUD

12.M0964090
TORSION SPRING:
FUSING ENTRANC
E GUIDE PLATE

19.M0964076
FUSING ENTRANC
E GUIDE PLATE:UP
PER

20.M0964077
FUSING ENTRANC
E GUIDE PLATE:LO
WER

14.M0964114
GUIDE PLATE:EXIT
:PRESSURE

9.M0964084
HOLDER:FUSING E
NTRANCE GUIDE P
LATE:RIGHT

11.M0964089
TORSION SPRING:
FUSING ENTRANC
E GUIDE PLATE:RI
GHT

22.M0964117
(x2)
DECAL:FUSING EXI
T:OPEN AND CLOS
E

2.07200030E
(x6)
RETAINING RING -
M3

1.04503010N
(x3)
TAPPING SCREW -
M3X10

4.8046123
(x21)
HEXAGONAL BOLT
:W/WASHER:M3X8

15.M0964115
TORSION SPRING:
GUIDE PLATE:PRE
SSURE:RIGHT

U007_S001
FUSING UNIT - 230V

24.M0964127
DECAL:FUSING:LE
VER:RIGHT

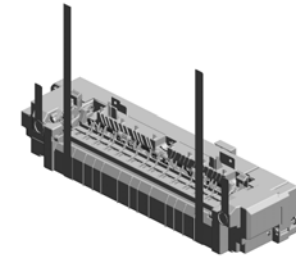

18.M0964027
FUSING UNIT - 230
V

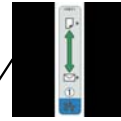

23.M0964126
DECAL:FUSING:LE
VER:LEFT

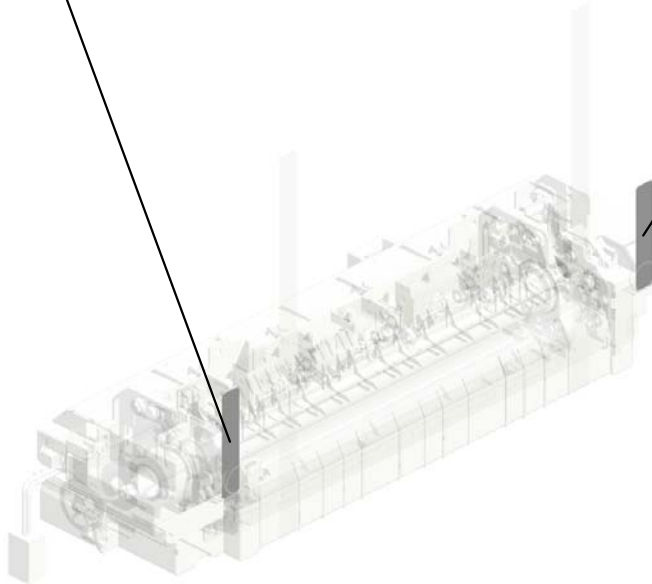

U001	U002	U003	U004	U005	U006	U007	U008	U009	U010	U011
------	------	------	------	------	------	------	------	------	------	------

U007_S002 FUSING UNIT - TWN 110V

7.GX450006
HEATER:110V:1000
W

8.GX450009
HEATER:230V:1000
W

21.M0964111
COVER:FUSING

13.M0964112
COVER:PRESSUR
E

5.AA143520
SHOULDER SCRE
W - M3

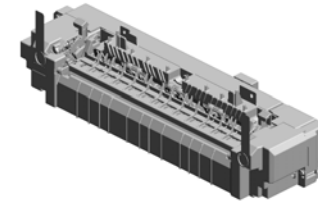

17.M0964019
FUSING UNIT - TW
N 110V

16.M0964116
TORSION SPRING:
GUIDE PLATE:PRE
SSURE:LEFT

3.07200040E
RETAINING RING -
M4

10.M0964085
HOLDER:FUSING E
NTRANCE GUIDE P
LATE:LEFT

6.G1664310
DECAL:WARNING (H
IGH TEMPERATU
RE):1:CUD

12.M0964090
TORSION SPRING:
FUSING ENTRANC
E GUIDE PLATE

19.M0964076
FUSING ENTRANC
E GUIDE PLATE:UP
PER

20.M0964077
FUSING ENTRANC
E GUIDE PLATE:LO
WER

14.M0964114
GUIDE PLATE:EXIT
:PRESSURE

9.M0964084
HOLDER:FUSING E
NTRANCE GUIDE P
LATE:RIGHT

11.M0964089
TORSION SPRING:
FUSING ENTRANC
E GUIDE PLATE:RI
GHT

22.M0964117
(x2)
DECAL:FUSING EXI
T:OPEN AND CLOS
E

2.07200030E
(x6)
RETAINING RING -
M3

1.04503010N
(x3)
TAPPING SCREW -
M3X10

4.8046123
(x21)
HEXAGONAL BOLT
:W/WASHER:M3X8

15.M0964115
TORSION SPRING:
GUIDE PLATE:PRE
SSURE:RIGHT

U007_S002
FUSING UNIT - TWN 110V

24.M0964127
DECAL:FUSING:LE
VER:RIGHT

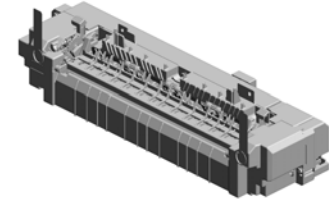

17.M0964019
FUSING UNIT - TW
N 110V



23.M0964126
DECAL:FUSING:LE
VER:LEFT

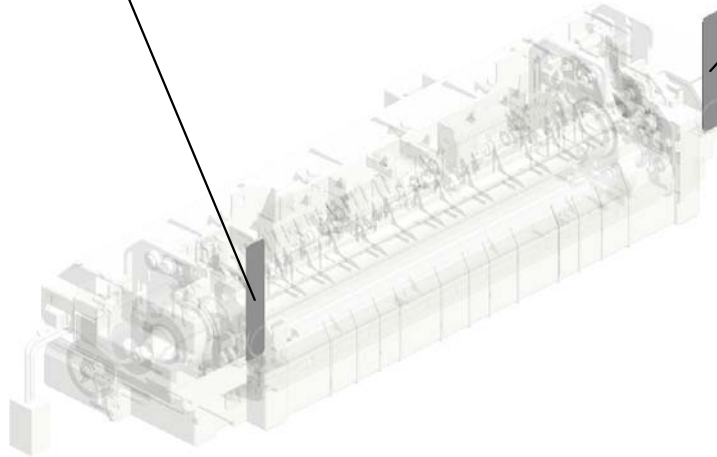

U001	U002	U003	U004	U005	U006	U007	U008	U009	U010	U011
------	------	------	------	------	------	------	------	------	------	------

U008.PAPER EXIT

U008_S001
M0964450
GUIDE.EXIT.ASS'Y

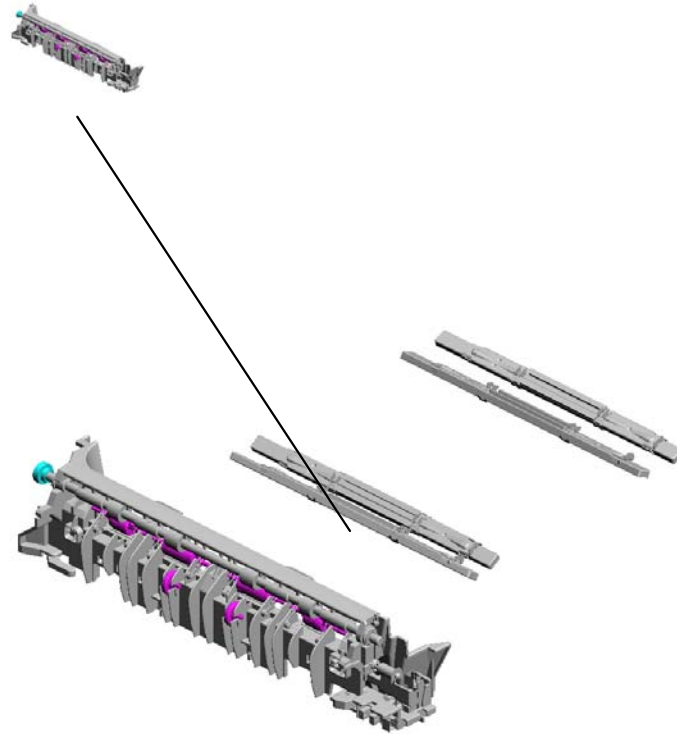

U001	U002	U003	U004	U005	U006	U007	U008	U009	U010	U011
------	------	------	------	------	------	------	-------------	------	------	------

U008
PAPER EXIT

3.8046123
(x2)
HEXAGONAL BOLT
:W/WASHER:M3X8

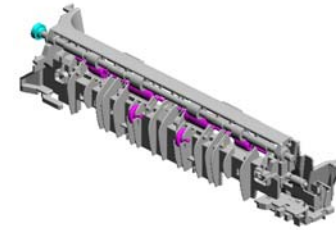

U008_S001
GUIDE:EXIT:ASS'Y

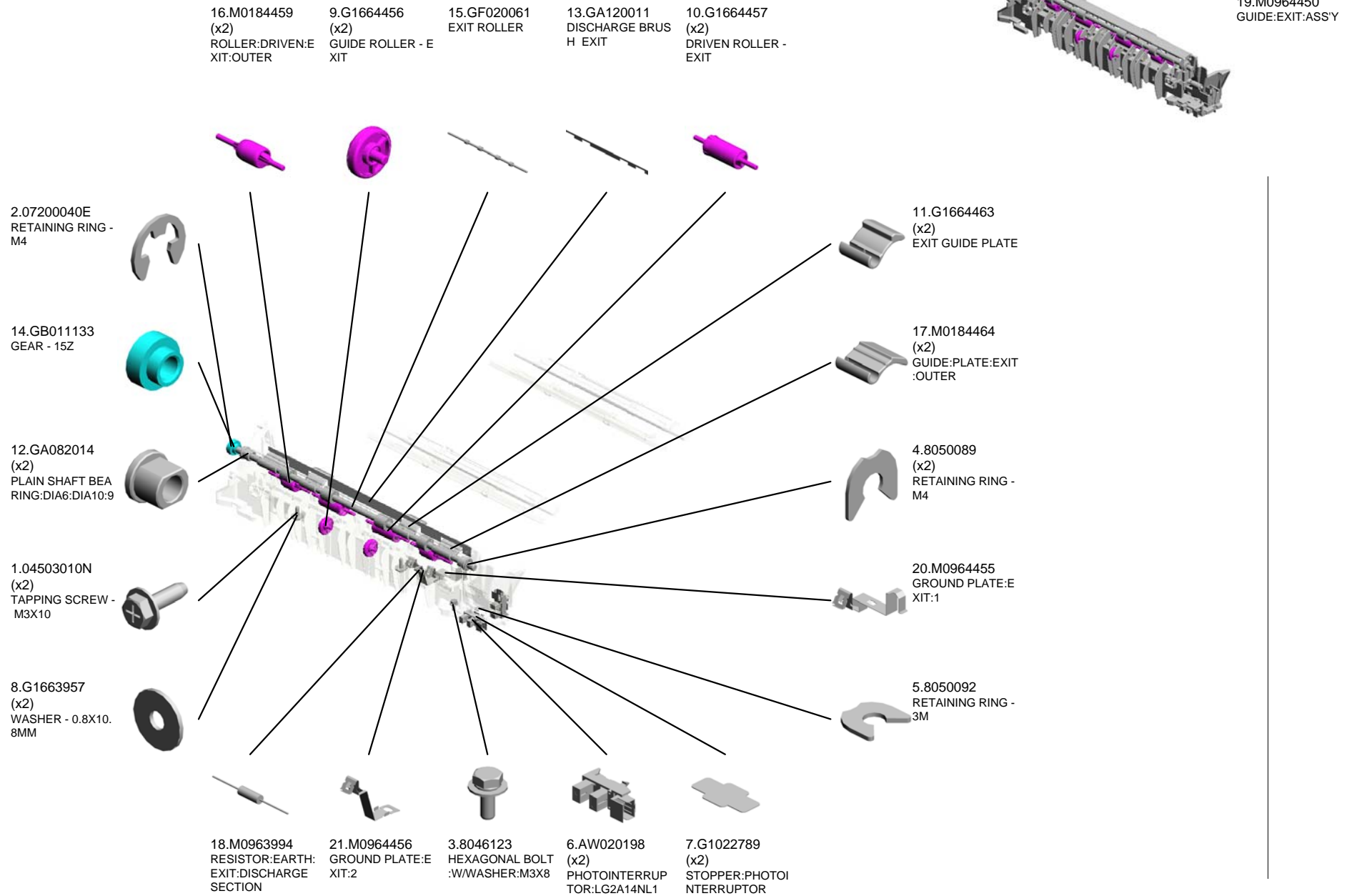

U001	U002	U003	U004	U005	U006	U007	U008	U009	U010	U011
------	------	------	------	------	------	------	------	------	------	------

U008_S001
GUIDE:EXIT:ASS'Y

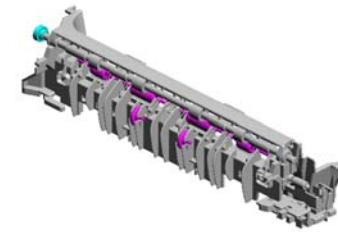

19.M0964450
GUIDE:EXIT:ASS'Y

24.M0964460
(x2)
SPRING:PRESSUR
E:EXIT:OUTER

26.M0964462
LINK:SLIDE

22.M0964458
(x2)
SPRING:PRESSUR
E:EXIT:INNER

28.M0964464
COMPRESSION SP
RING

23.M0964459
FEELER:L

29.M0964465
TORSION SPRING:
1

27.M0964463
LINK:TURN

30.M0964466
TORSION SPRING:
2

25.M0964461
FEELER:R

U001	U002	U003	U004	U005	U006	U007	U008	U009	U010	U011
------	------	------	------	------	------	------	------	------	------	------

U009 MAIN DRIVE

5.04503010N (x18) TAPPING SCREW - M3X10
 14.G1661123 (x6) FRAME - ON-OFF DRIVE UNIT
 1.03530030N (x6) SCREW:M3X3
 10.AA082101 (x2) BUSHING - 6X10X6
 3.03530060N (x2) BIND SCREW - M3 X6

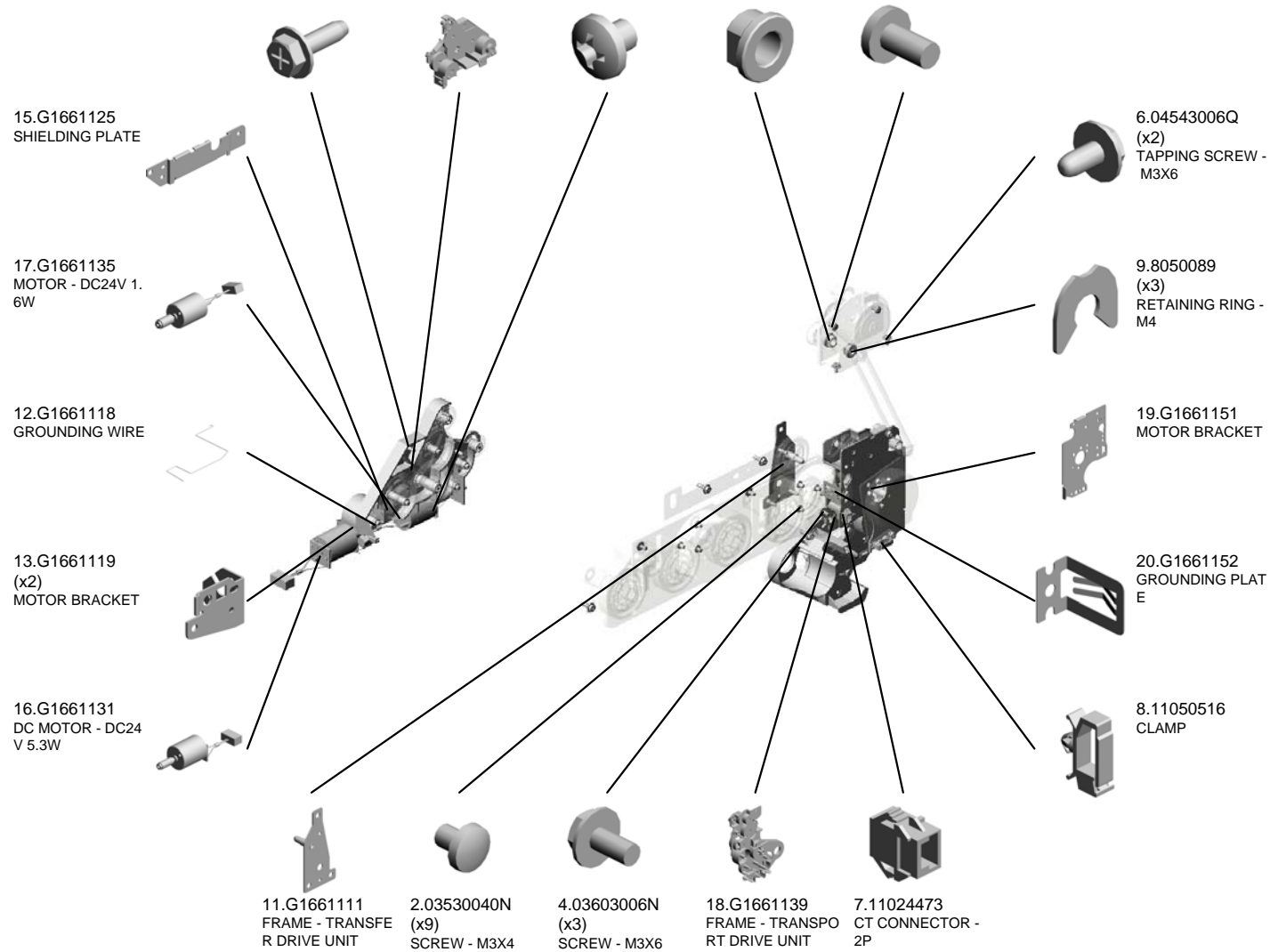
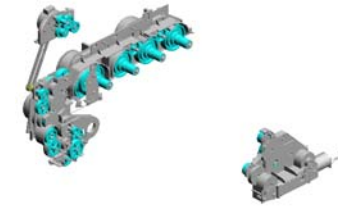

U009 MAIN DRIVE

37.GB011108
(x2)
GEAR - 21Z

26.GA145014
SHAFT - 6 X 55.3M
M

40.GB011111
GEAR - 19Z

22.G1665745
HARNES COVER

21.G1661194
FRAME - DUPLEX
DRIVE UNIT

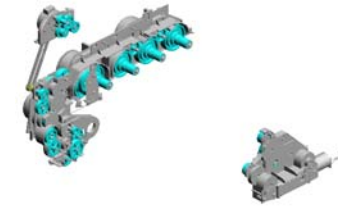

23.GA043030
TIMING BELT - 60S
2M280

32.GB011102
GEAR - 19/38Z

27.GA148016
SHAFT - 6 X 26.7M
M

24.GA132101
(x5)
SPACER - 0.13 X 1
2MM

29.GB010039
(x2)
GEAR:AIO:DRIVE:M
IDDLE

30.GB010040
GEAR:AIO:DRIVE:1

38.GB011109
(x2)
GEAR - 28Z

34.GB011104
GEAR - 20/35Z

36.GB011106
GEAR - 22/31Z

35.GB011105
GEAR - 29Z

25.GA145013
SHAFT - 6 X 39.5M
M

28.GA148018
(x2)
SHAFT - 6 X 21.9M
M

31.GB011101
GEAR - 37Z

39.GB011110
GEAR - 31Z

33.GB011103
GEAR - 28/36Z

U009 MAIN DRIVE

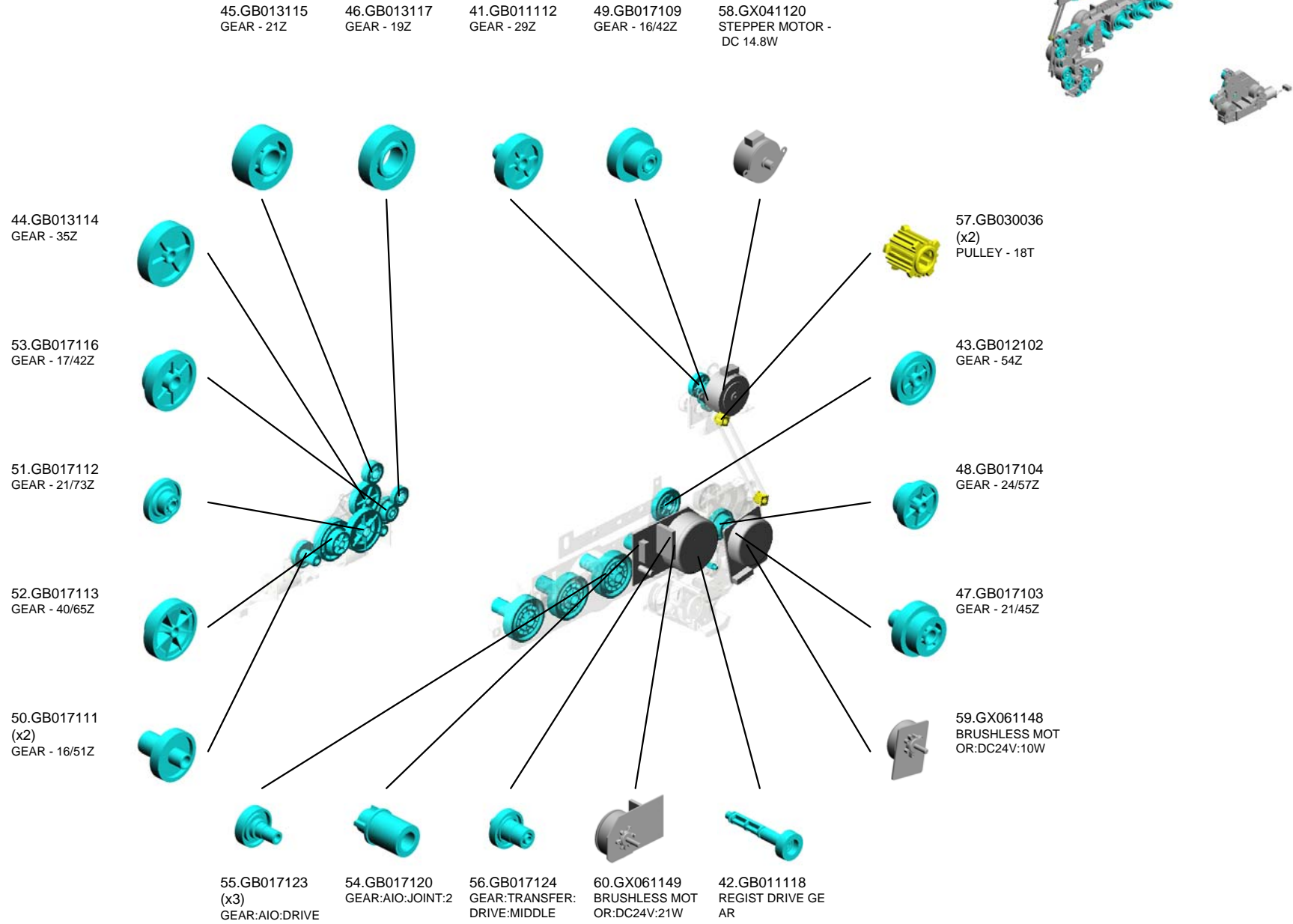

U001	U002	U003	U004	U005	U006	U007	U008	U009	U010	U011
------	------	------	------	------	------	------	------	------	------	------

U009 MAIN DRIVE

64.M0751107
SHIELDING PLATE:
GEAR:2

61.GX061150
BRUSHLESS MOT
OR:DC24V:35W

62.GX201123
MAGNETIC CLUTCH
H:0.25N

63.M0751105
BRACKET:MOTOR

U001	U002	U003	U004	U005	U006	U007	U008	U009	U010	U011
------	------	------	------	------	------	------	------	------	------	------

U010.ELECTRICAL

U010_S001
G1666003
DENSITY SENSOR:ASS'Y

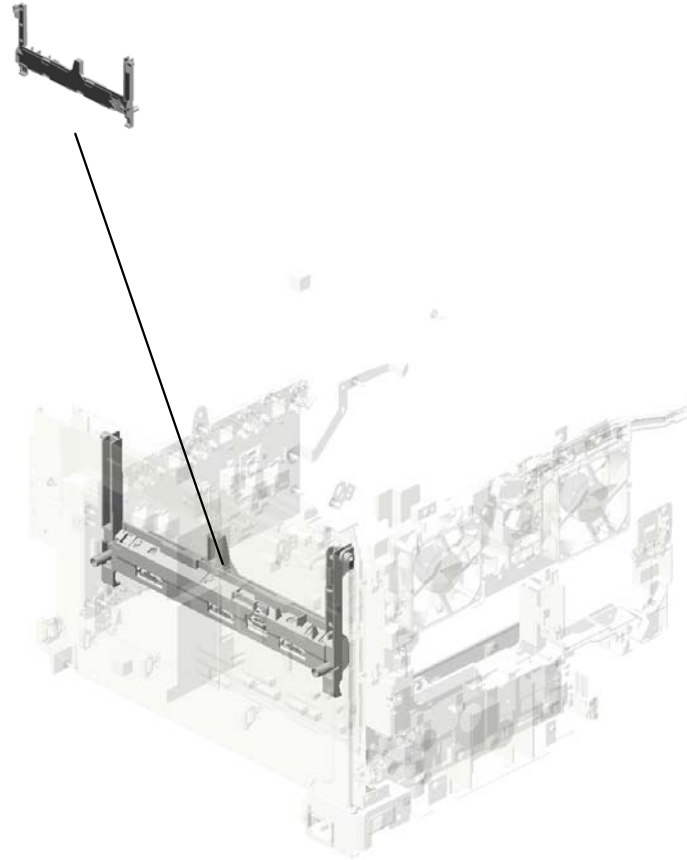

U001	U002	U003	U004	U005	U006	U007	U008	U009	U010	U011
------	------	------	------	------	------	------	------	------	------	------

U010 ELECTRICAL

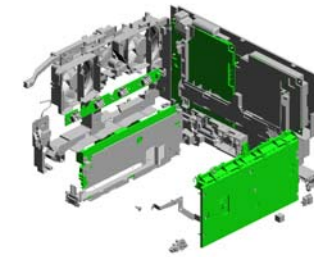

- 4.04543006Q (x12) TAPPING SCREW - M3X6
- 19.G1022789 STOPPER:PHOTO INTERRUPTOR
- 10.11050508 (x4) HARNESS CLAMP - LWS-0711
- 14.14075317 EEPROM:M24C16-WBN6(REV.SW/G)
- 20.G1631068 (x2) BRACKET - PHOTO INTERRUPTOR

1.03530040N
SCREW - M3X4

11.11050516
(x2)
CLAMP

12.11050724
[A]
CLAMPS:WES-1210
201504-01 O/O

17.AW140015
TEMPERATURE &
HUMIDITY SENSO
R

9.11050487
(x2)
HARNESS CLAMP

3.04503010N
(x34)
TAPPING SCREW -
M3X10

2.03603006N
(x10)
SCREW - M3X6

7.11024559
CONNECTOR - 3P

16.AA143592
SCREW - M4X6

6.09543008N
(x2)
SCREW - M3X8

13.12042612
(x3)
MICRO SWITCH:D3
V-16506-3C25

5.04543008Q
(x2)
TAPPING SCREW:3
X8

18.AX640199
(x2)
FAN:MM80:25MM:D
C 2.16W

15.8046123
(x4)
HEXAGONAL BOLT
:W/WASHER:M3X8

8.11033902
CONNECTOR - 10P

U001	U002	U003	U004	U005	U006	U007	U008	U009	U010	U011
------	------	------	------	------	------	------	------	------	------	------

U010 ELECTRICAL

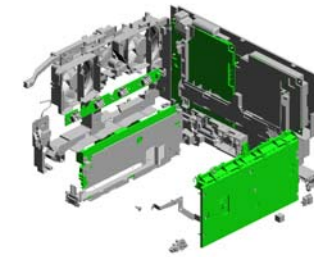

- 27.G1665708 2ND TERMINAL- T RANSFER
- 21.G1635728 (x4) SEAL:FAN:2
- 34.G1665733 LINK - SAFETY SWI TCH
- 36.G1665736 TENSION SPRING - SAFETY SWITCH
- 35.G1665734 TORSION SPRING - SAFETY SWITCH

29.G1665716 (x16) TERMINAL:AIO

38.G1665738 1ST TERMINAL - T RANSFER

30.G1665725 HARNESS COVER

32.G1665730 CONTROLLER CO VER

31.G1665726 (x2) CUSHION - HARNE SS

28.G1665715 BRACKET - MAIN S WITCH

23.G1661059 DUCT

26.G1665700 BRACKET - POWE R SUPPLY UNIT

25.G1665280 TERMINAL BOARD

24.G1661110 HARNESS GUIDE

39.G1665748 LEVER - SAFETY S WITCH

37.G1665737 COMPRESSION SP RING - SAFETY SW ITCH

33.G1665732 BRACKET SAFETY SWITCH

22.G1661058 EXIT DUCT

40.G1665751 CONNECTOR HOL DER - FUSING

U010 ELECTRICAL

56.M0955652 PCB:CTL:PGDI:ASS 'Y for M095
58.M0965652 PCB:CTL:PPCL:AS S'Y
55.GZ300004 POWER PACK 201207-01 O/O
51.G1666586 FEELER - SET SENSOR
57.M0965126 PCB:EGB:ASSY

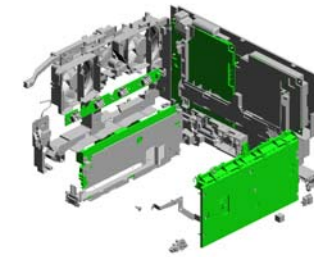

44.G1666045
SPRING - FEELER

45.G1666046
SENSOR FEELER

46.G1666103
SENSOR HOLDER

52.G1666587
SENSOR BRACKET

50.G1666584
USED TONER SENSOR

49.G1666580
STOPPER SHEET - PHOTOINTERRUPTOR

47.G1666107
GROUNDING PLATE

41.G1665754
ARM:LINK:SAFETY SWITCH

59.M0965711
SHADEING PLATE: HARNESS:POWER SUPPLY UNIT

42.G1665759
GROUND PLATE - FUSING

53.GZ230061
POWER SUPPLY UNIT:NA/TWN:139W

54.GZ230062
POWER SUPPLY UNIT:EU/AA/CHN:139W



U010_S001
DENSITY SENSOR:ASS'Y

48.G1666191
CLEANER DECAL -
DENSITY SENSOR



43.G1666003
DENSITY SENSOR:
ASS'Y

U001	U002	U003	U004	U005	U006	U007	U008	U009	U010	U011
------	------	------	------	------	------	------	------	------	------	------

U011.MAIN FRAME

U011_S001
G1661240
BRAKE:COVER:UPPER

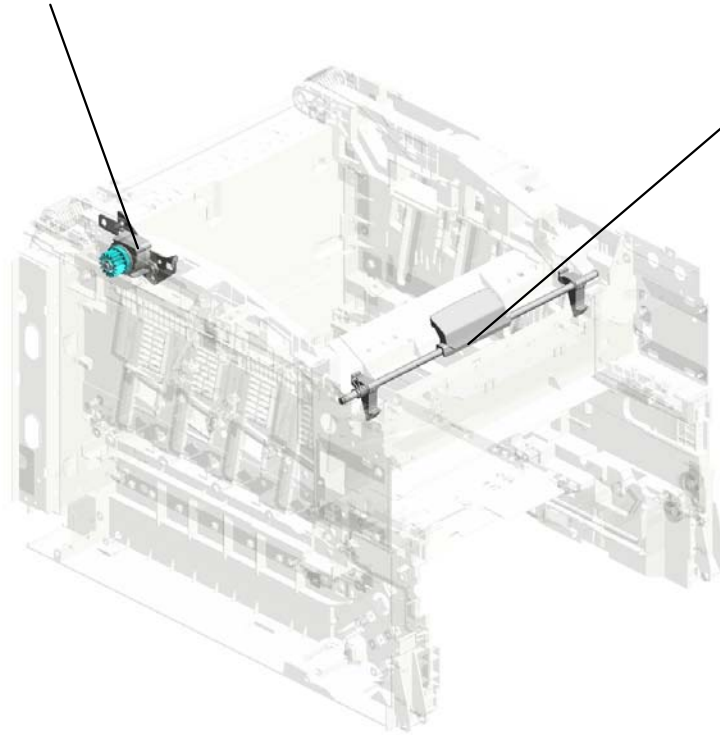

U011_S002
G1661012
LOCK SHAFT



U001	U002	U003	U004	U005	U006	U007	U008	U009	U010	U011
------	------	------	------	------	------	------	------	------	------	------

U011 MAIN FRAME

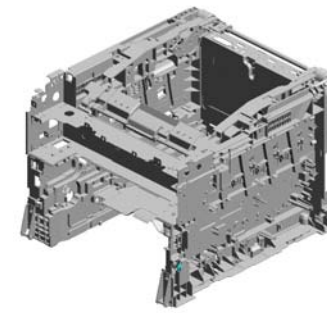

- | | | | | |
|---|--|--|---|-------------------------------------|
| 4.04503016N
(x2)
TAPPING SCREW:3
X16 | 14.G1661046
COLOR DECAL - M
AGENTA | 3.04503010N
(x33)
TAPPING SCREW -
M3X10 | 9.07200040E
(x4)
RETAINING RING -
M4 | 1.03530040N
(x2)
SCREW - M3X4 |
|---|--|--|---|-------------------------------------|

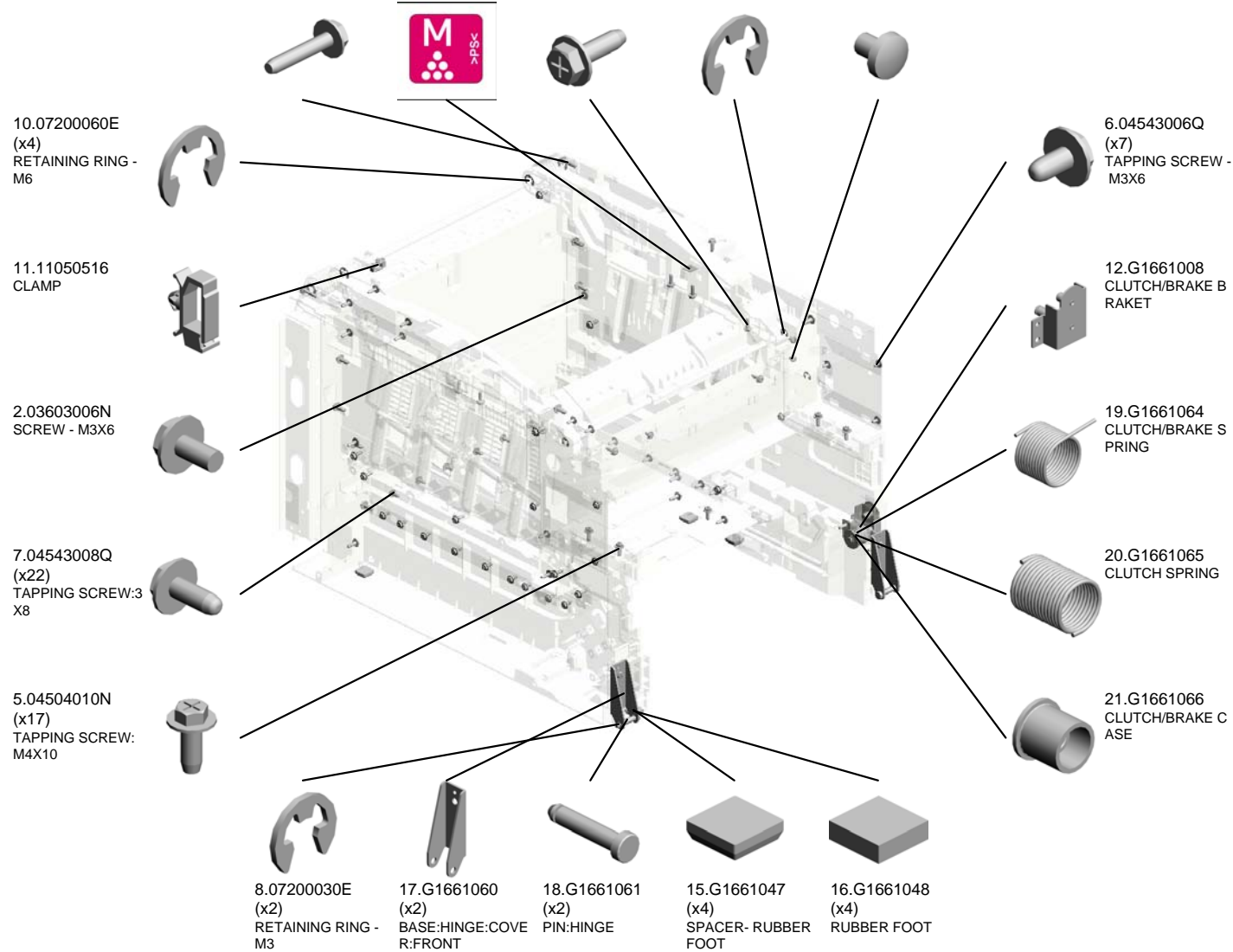

U011 MAIN FRAME

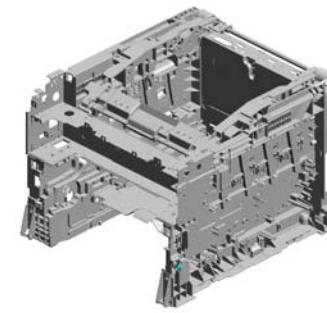

- 28.G1661073 SHAFT
- 25.G1661070 FRAME:UPPER LEFT
- 27.G1661072 (x4) SPRING:PLATE:AIO
- 30.G1661080 TWIST SPRING - RIGHT
- 26.G1661071 FRAME:UPPER RIGHT

31.G1661081
TWIST SPRING - LEFT

37.G1661089
(x8)
PIN:PLATE:DEVELOPMENT UNIT

29.G1661078
(x2)
COMPRESSION SPRING

35.G1661087
(x2)
SPRING:CUSHION:FRAME:UPPER

34.G1661086
(x2)
BRACKET:OPTICAL UNIT:FRAME:UPPER

38.G1661090
GROUND PLATE - DCHIP

33.G1661084
(x4)
SPRING:PLATE:AIO:BLACK

41.G1661096
GROUND PLATE - FRONT

23.G1661068
FUSING DUCT

40.G1661095
(x3)
SHEET:BASE:FRAME

32.G1661083
GROUNDING PLATE - HIGH VOLTAGE

36.G1661088
UPPER FRONT DUCT

24.G1661069
RACK SUPPORTER

39.G1661093
GEAR - 20Z

22.G1661067
GEAR - 14Z

U011 MAIN FRAME

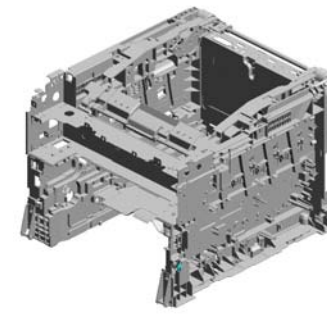

49.G1661316
(x2)
LOWER SEAL - 3

52.G1661343
KEY:FUSING

66.G1663333
DECAL - CYAN

67.G1663334
DECAL - YELLOW

50.G1661323
(x3)
SHEET:FRAME:RIG
HT



51.G1661342
RACK:DAMPER

65.G1663331
DECAL - BLACK

46.G1661280
CUSHION - IMAGIN
G UNIT

57.G1662582
GROUNDING SPRI
NG

42.G1661097
GROUND PLATE -
LEFT

58.G1662583
SPRING PLATE:PA
PER TRAY:POSITI
ONING

43.G1661112
GEAR COVER

48.G1661315
(x3)
LOWER SEAL - 2

61.G1662588
HOLDER:PAPER T
RAY:POSITIONING

47.G1661314
LOWER SEAL - 1

62.G1662596
HOLDER:RESISTO
R:BASE

64.G1662598
SPRING PLATE:RE
SISTOR:BASE:UPP
ER

63.G1662597
SPRING PLATE:RE
SISTOR:BASE:LOW
ER

60.G1662586
FEELER HOLDER

59.G1662585
FEELER - PAPER E
ND SENSOR

U011 MAIN FRAME

76.M1981085
SPRING PLATE:LS
U:POSITIONING
201309-02 X/O

73.M0965703
DC SOLENOID:FUS
ING:ASS'Y

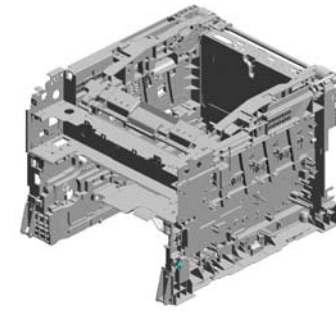

68.G1665706
GROUND PLATE:S
HAFT:IMAGING UNI
T



69.G1665724
HARNESS CLAMP
HOLDER

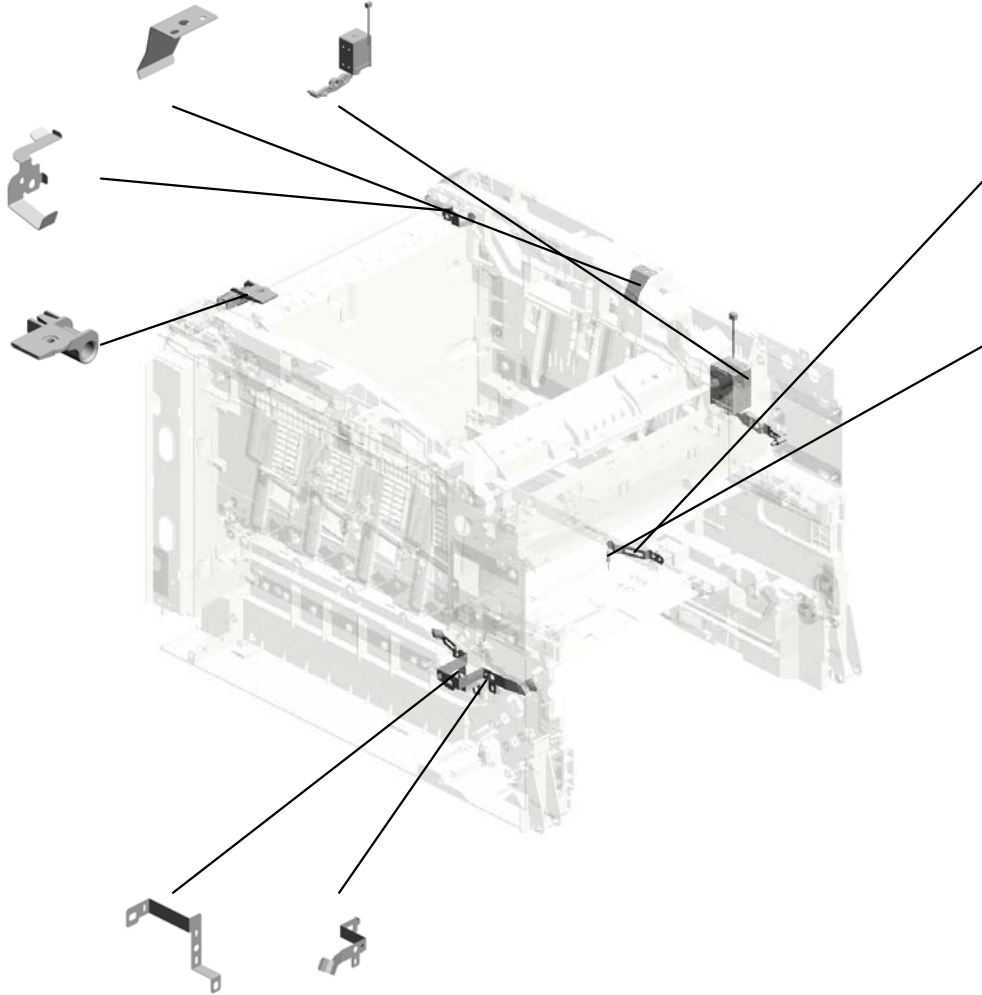

70.G1666592
(x2)
SPRING PLATE -C
OLLECTION BOTTL
E



72.M0963993
RESISTOR:EARTH:
PAPER FEED



75.M0965761
GROUND PLATE:B
ASE:PSU

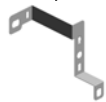

74.M0965760
GROUND PLATE:R
EGISTRATION ROL
LER



U011_S001
BRAKE:COVER:UPPER

54.G1661384
GEAR - 15Z

2.03603006N
(x2)
SCREW - M3X6

56.G1661387
CLUTCH SPRING

44.G1661240
BRAKE:COVER:UP
PER

9.07200040E
RETAINING RING -
M4

45.G1661241
BRAKE BRACKET

55.G1661386
BRAKE SPRING

53.G1661383
BRAKE COLLER

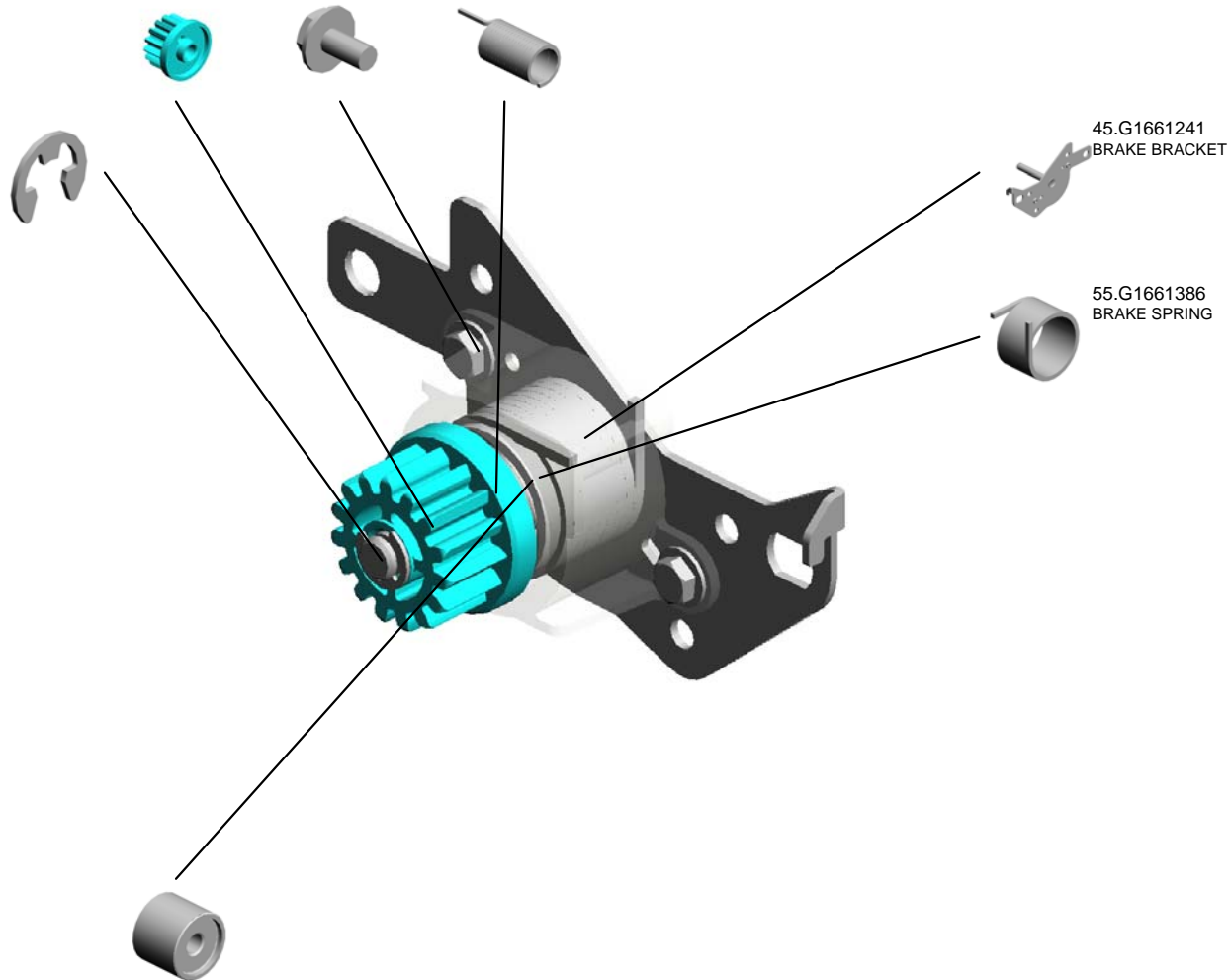

U001	U002	U003	U004	U005	U006	U007	U008	U009	U010	U011
------	------	------	------	------	------	------	------	------	------	------

U011_S002
LOCK SHAFT

9.07200040E
RETAINING RING -
M4

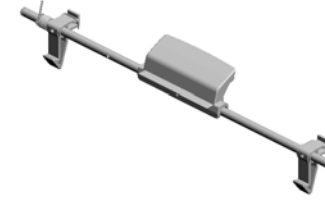

13.G1661012
LOCK SHAFT



U001	U002	U003	U004	U005	U006	U007	U008	U009	U010	U011
------	------	------	------	------	------	------	------	------	------	------

ACCESSORIES



1.11500409
(-19):POWER SUPPLY CORD -125V 1
5A TWN



2.11500457
POWER SUPPLY CODE:250V:10A:EU
201411-01 O/O



3.G1661268
LOGO PLATE - RIC



4.G1661390
CAUTION DECAL - TRANSFER BELT



5.G1662592
SIDE FENCE DECAL



6.J0121515
LOGO PLATE - NSA



7.J0121516
LOGO PLATE - REX



8.J0121517
LOGO PLATE - GES



9.M0951381
DECAL:NAME PLATE:M095:RICOH



10.M0961384
DECAL:NAME PLATE:M096:NAS



11.M0961385
DECAL:NAME PLATE:M096:REX



12.M0961386
DECAL:NAME PLATE:M096:GES



13.M0964128
DECAL:CAUTION:FUSING PRESSUR
E RELEASE

DECALS AND DOCUMENTS



1.G1661046
COLOR DECAL - MAGENTA



2.G1661268
LOGO PLATE - RIC



3.G1661390
CAUTION DECAL - TRANSFER BELT



4.G1662592
SIDE FENCE DECAL



5.G1662593
(x2)
Caution Decal - Inkjet Paper

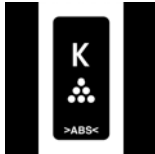

6.G1663331
DECAL - BLACK

DECALS AND DOCUMENTS



7.G1663333
Decal - Cyan



8.G1663334
Decal - Yellow



9.G1664310
Decal:Warning (high Temperature):1:C
ud



10.G1664464
Decal:Hightemperature



11.G1666191
Cleaner Decal - Density Sensor



12.J0121515
LOGO PLATE - NSA



13.J0121516
LOGO PLATE - REX



14.J0121517
LOGO PLATE - GES



15.M0961381
DECAL:NAME PLATE:M096:RICOH



16.M0961384
DECAL:NAME PLATE:M096:NAS



17.M0961385
DECAL:NAME PLATE:M096:REX



18.M0961386
DECAL:NAME PLATE:M096:GES



19.M0963987
Decal:Grip:Housing



20.M0963988
Decal:Insert Sub-unit:Transport Unit



21.M0964117
Decal:Fusing Exit:Open And Close

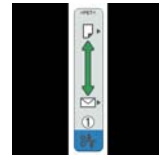

22.M0964126
Decal:Fusing:Lever:Left



23.M0964127
Decal:Fusing:Lever:Right



24.M0964128
DECAL:CAUTION:FUSING PRESSUR
E RELEASE

Exclusive Parts

Number	Part Name	Group	ID
52152713	BOTTOM PLATE PAD	U004_S001_S001	2
8046123	HEXAGONAL BOLT:W/WASHER:M3X8	U007_S001	4
		U007_S002	4
		U008	3
		U008_S001	3
		U010	15
8050088	RETAINING RING - M6	U004_S001	3
8050089	RETAINING RING - M4	U004	4
		U006_S001	3
		U008_S001	4
		U009	9
8050092	RETAINING RING - 3M	U008_S001	5
A2672869	GEAR - 16Z	U004_S001	5
AA082101	BUSHING - 6X10X6	U004	6
		U009	10
AA132013	SPACER	U004_S001	7
AA143520	SHOULDER SCREW - M3	U007_S001	5
		U007_S002	5
AA143592	SCREW- M4X6	U010	16
AF031061	PAPER FEED ROLLER	U004	8
AW020198	PHOTOINTERRUPTOR:LG2A14NL1	U008_S001	6
AW140015	TEMPERATURE & HUMIDITY SENSOR	U010	17
AX640199	FAN:MM80:25MM:DC 2.16W	U010	18
D0094511	SPACER:DIA8.0:1.5MM	U004_S001	9
G1022789	STOPPER:PHOTOINTERRUPTOR	U008_S001	7
		U010	19
G1631068	BRACKET - PHOTOINTERRUPTOR	U010	20
G1635728	SEAL:FAN:2	U010	21
G1661008	CLUTCH/BRAKE BRAKET	U011	12
G1661012	LOCK SHAFT	U011_S002	13
G1661046	COLOR DECAL - MAGENTA	DECALS AND DOCUMENTS	1
		U011	14
G1661047	SPACER- RUBBER FOOT	U011	15
G1661048	RUBBER FOOT	U011	16
G1661058	EXIT DUCT	U010	22
G1661059	DUCT	U010	23

Number	Part Name	Group	ID
G1661060	BASE:HINGE:COVER:FRONT	U011	17
G1661061	PIN:HINGE	U011	18
G1661064	CLUTCH/BRAKE SPRING	U011	19
G1661065	CLUTCH SPRING	U011	20
G1661066	CLUTCH/BRAKE CASE	U011	21
G1661067	GEAR - 14Z	U011	22
G1661068	FUSING DUCT	U011	23
G1661069	RACK SUPPORTER	U011	24
G1661070	FRAME:UPPER LEFT	U011	25
G1661071	FRAME:UPPER RIGHT	U011	26
G1661072	SPRING:PLATE:AIO	U011	27
G1661073	SHAFT	U011	28
G1661078	COMPRESSION SPRING	U011	29
G1661080	TWIST SPRING - RIGHT	U011	30
G1661081	TWIST SPRING - LEFT	U011	31
G1661083	GROUNDING PLATE - HIGH VOLTAGE	U011	32
G1661084	SPRING:PLATE:AIO:BLACK	U011	33
G1661086	BRACKET:OPTICAL UNIT:FRAME:UPPER	U011	34
G1661087	SPRING:CUSHION:FRAME:UPPER	U011	35
G1661088	UPPER FRONT DUCT	U011	36
G1661089	PIN:PLATE:DEVELOPMENT UNIT	U011	37
G1661090	GROUND PLATE - DCHIP	U011	38
G1661093	GEAR - 20Z	U011	39
G1661095	SHEET:BASE:FRAME	U011	40
G1661096	GROUND PLATE - FRONT	U011	41
G1661097	GROUND PLATE - LEFT	U011	42
G1661110	HARNESS GUIDE	U010	24
G1661111	FRAME - TRANSFER DRIVE UNIT	U009	11
G1661112	GEAR COVER	U011	43
G1661118	GROUNDING WIRE	U009	12
G1661119	MOTOR BRACKET	U009	13
G1661123	FRAME - ON-OFF DRIVE UNIT	U009	14
G1661125	SHIELDING PLATE	U009	15
G1661131	DC MOTOR - DC24V 5.3W	U009	16
G1661135	MOTOR - DC24V 1.6W	U009	17
G1661139	FRAME - TRANSPORT DRIVE UNIT	U009	18

Exclusive Parts

Number	Part Name	Group	ID
G1661151	MOTOR BRACKET	U009	19
G1661152	GROUNDING PLATE	U009	20
G1661194	FRAME - DUPLEX DRIVE UNIT	U009	21
G1661240	BRAKE:COVER:UPPER	U011_S001	44
G1661241	BRAKE BRACKET	U011_S001	45
G1661260	EXTEND TRAY	U001	7
G1661261	INNER COVER - EXIT	U001	8
G1661262	CASSETTE COVER	U001	9
G1661268	LOGO PLATE - RIC	ACCESSORIES	3
		DECALS AND DOCUMENTS	2
G1661269	STOPPER BAND	U001	10
G1661280	CUSHION - IMAGING UNIT	U011	46
G1661281	BASE - EXIT END FENCE	U001	11
G1661282	REAR END FENCE - EXIT	U001	12
G1661283	FRONT END FENCE - EXIT	U001	13
G1661300	COVER:UPPER	U001	14
G1661308	INTERFACE COVER	U001	15
G1661311	SEAL - 5X15X222MM	U001	16
G1661312	SEAL - 7X25X176MM	U001	17
G1661313	SEAL - 3X8X411MM	U001	18
G1661314	LOWER SEAL - 1	U011	47
G1661315	LOWER SEAL - 2	U011	48
G1661316	LOWER SEAL - 3	U011	49
G1661317	SEAL - 4X30X30MM	U001	19
G1661318	SHEET - CASSETTE COVER	U001	20
G1661319	SEAL:COVER:LEFT:7	U001	21
G1661320	SEAL:COVER:LEFT:6	U001	22
G1661323	SHEET:FRAME:RIGHT	U011	50
G1661333	COVER:RIGHT:EU	U001	23
G1661342	RACK:DAMPER	U011	51
G1661343	KEY:FUSING	U011	52
G1661383	BRAKE COLLER	U011_S001	53
G1661384	GEAR - 15Z	U011_S001	54
G1661386	BRAKE SPRING	U011_S001	55
G1661387	CLUTCH SPRING	U011_S001	56
G1661390	CAUTION DECAL - TRANSFER BELT	ACCESSORIES	4
		DECALS AND DOCUMENTS	3

Number	Part Name	Group	ID
		CUMENTS	
G1662552	PAPER TRAY - FRONT	U004_S001	10
G1662553	CASSETTE COVER	U004_S001	11
G1662554	DUPLEX GUIDE	U004	12
G1662555	LEFT SIDE FENCE	U004_S001	13
G1662556	RIGHT SIDE FENCE	U004_S001	14
G1662558	EXTENSION TRAY	U004_S001	15
G1662559	END FENCE	U004_S001	16
G1662567	BOTTOM PLATE STOPPER	U004_S001	17
G1662568	COMPRESSION SPRING	U004_S001	18
G1662569	LEVER PAPER VOLUME SENSOR	U004_S001	19
G1662570	COMPRESSION SPRING	U004_S001	20
G1662571	SHEET - CASSETTE	U004_S001	21
G1662572	EARTH SPRING	U004_S001	22
G1662573	HOLDER SHEET	U004_S001	23
G1662577	END FENCE - PRESSURE	U004_S001	24
G1662578	COMPRESSION SPRING	U004_S001	25
G1662582	GROUNDING SPRING	U011	57
G1662583	SPRING PLATE:PAPER TRAY:POSITIONING	U011	58
G1662585	FEELER - PAPER END SENSOR	U011	59
G1662586	FEELER HOLDER	U011	60
G1662588	HOLDER:PAPER TRAY:POSITIONING	U011	61
G1662589	DAMPING INSULATION	U004_S001	26
G1662592	SIDE FENCE DECAL	ACCESSORIES	5
		DECALS AND DOCUMENTS	4
G1662593	Caution Decal - Inkjet Paper	DECALS AND DOCUMENTS	5
G1662596	HOLDER:RESISTOR:BASE	U011	62
G1662597	SPRING PLATE:RESISTOR:BASE:LOWER	U011	63
G1662598	SPRING PLATE:RESISTOR:BASE:UPPER	U011	64
G1662606	COMPRESSION SPRING	U004_S001	27
G1663331	DECAL - BLACK	DECALS AND DOCUMENTS	6

Exclusive Parts

Number	Part Name	Group	ID
		U011	65
G1663333	DECAL - CYAN	DECALS AND DOCUMENTS	7
		U011	66
G1663334	DECAL - YELLOW	DECALS AND DOCUMENTS	8
		U011	67
G1663852	REGISTRATION ROLLER - DRIVEN	U006_S001	4
G1663855	TENSION SPRING	U006_S001	5
G1663859	REGISTRATION SENSOR FEELER	U006_S001	6
G1663860	TORSION SPRING	U006_S001	7
G1663862	GUIDE SHEET - REGISTRATION	U006_S001	8
G1663863	REGISTRATION GUIDE	U006_S001	9
G1663865	GEAR - 14Z	U006_S001	10
G1663867	DRIVE GEAR - 14Z	U006_S001	11
G1663903	RIGHT FRAME - FRONT COVER	U001	24
G1663904	LEFT FRAME - FRONT COVER	U001	25
G1663905	RIGHT LOCK LEVER	U001	26
G1663906	LEFT LOCK LEVER	U001	27
G1663907	LOCK GUIDE	U001	28
G1663908	LOCK LEVER ARM	U001	29
G1663909	TENSION SPRING	U001	30
G1663910	GROUND WIRE	U001	31
G1663921	GUIDE PLATE SPRING - MIDDLE	U001	32
G1663925	TORSION SPRING - FEELER	U001	33
G1663927	STOPPER BAND	U001	34
G1663928	BRAKE RACK - FRONT COVER	U001	35
G1663933	STOPPER:FEELER:PAPER FEED SENSOR	U001	36
G1663957	WASHER - 0.8X10.8MM	U001	37
		U008_S001	8
G1663961	COMPRESSION SPRING	U006_S001	12
G1663962	COMPRESSION SPRING HOLDER	U001	38
G1663965	GROUND WIRE	U006_S001	13
G1663967	ELECTRODE PLATE - LINK	U006_S001	14
G1663968	ELECTRODE PLATE - CONTACT POINT	U006_S001	15
G1663970	LEFT HOOK	U001	39

Number	Part Name	Group	ID
G1663971	RIGHT FHOOK	U001	40
G1663972	COMPRESSION SPRING - GRIP	U001	41
G1663983	SPACER:GROUND PLATE:TRANSFER	U006_S001	16
G1663997	GROUND WIRE:TRANSFER/SEPARATION	U006_S001	17
G1663998	GROUND WIRE- DUPLEX	U006_S001	18
G1664310	DECAL:WARNING (HIGH TEMPERATURE):1:CUD	DECALS AND DOCUMENTS	9
		U007_S001	6
		U007_S002	6
G1664456	GUIDE ROLLER - EXIT	U008_S001	9
G1664457	DRIVEN ROLLER - EXIT	U008_S001	10
G1664463	EXIT GUIDE PLATE	U008_S001	11
G1664464	DECAL:HIGHTEMPERATURE	DECALS AND DOCUMENTS	10
		U001	42
G1664606	DUPLEX ROLLER	U001	43
G1665280	TERMINAL BOARD	U010	25
G1665700	BRACKET - POWER SUPPLY UNIT	U010	26
G1665705	SHIELDING PLATE	U001	44
G1665706	GROUND PLATE:SHAFT:IMAGING UNIT	U011	68
G1665708	2ND TERMINAL- TRANSFER	U010	27
G1665715	BRACKET - MAIN SWITCH	U010	28
G1665716	TERMINAL:AIO	U010	29
G1665724	HARNESS CLAMP HOLDER	U011	69
G1665725	HARNESS COVER	U010	30
G1665726	CUSHION - HARNESS	U010	31
G1665730	CONTROLLER COVER	U010	32
G1665732	BRACKET SAFETY SWITCH	U010	33
G1665733	LINK - SAFETY SWITCH	U010	34
G1665734	TORSION SPRING - SAFETY SWITCH	U010	35
G1665736	TENSION SPRING - SAFETY SWITCH	U010	36
G1665737	COMPRESSION SPRING - SAFETY SWITCH	U010	37

Exclusive Parts

Number	Part Name	Group	ID
G1665738	1ST TERMINAL - TRANSFER	U010	38
G1665745	HARNESS COVER	U009	22
G1665748	LEVER - SAFETY SWITCH	U010	39
G1665751	CONNECTOR HOLDER - FUSING	U010	40
G1665754	ARM:LINK:SAFETY SWITCH	U010	41
G1665759	GROUND PLATE - FUSING	U010	42
G1666003	DENSITY SENSOR:ASS'Y	U010_S001	43
G1666026	BUSHING - 19MM	U005_S001	3
G1666045	SPRING - FEELER	U010	44
G1666046	SENSOR FEELER	U010	45
G1666099	COMPRESSION SPRING	U005_S001	4
G1666103	SENSOR HOLDER	U010	46
G1666107	GROUNDING PLATE	U010	47
G1666191	CLEANER DECAL - DENSITY SENSOR	DECALS AND DOCUMENTS	11
		U010_S001	48
G1666193	LEFT HOLDER - TRANSFER BELT UNIT	U005_S001	5
G1666194	RIGHT HOLDER - TRANSFER BELT UNIT	U005_S001	6
G1666196	RIGHT SLIDER - TRANSFER BELT UNIT	U005_S001	7
G1666197	LEFT SLIDER - TRANSFER BELT UNIT	U005_S001	8
G1666580	STOPPER SHEET - PHOTOINTERUPTOR	U010	49
G1666584	USED TONER SENSOR	U010	50
G1666586	FEELER - SET SENSOR	U010	51
G1666587	SENSOR BRACKET	U010	52
G1666592	SPRING PLATE -COLLECTION BOTTLER	U011	70
G8003133	SIDE FENCE GEAR	U004_S001	28
GA043030	TIMING BELT - 60S2M280	U009	23
GA082014	PLAIN SHAFT BEARING:DIA6:DIA10:9	U008_S001	12
GA082015	PLAIN SHAFT BEARING:DIA6:DIA9:7	U006_S001	19
GA120011	DISCHARGE BRUSH EXIT	U008_S001	13

Number	Part Name	Group	ID
GA132101	SPACER - 0.13 X 12MM	U009	24
GA145013	SHAFT - 6 X 39.5MM	U009	25
GA145014	SHAFT - 6 X 55.3MM	U009	26
GA148016	SHAFT - 6 X 26.7MM	U009	27
GA148018	SHAFT - 6 X 21.9MM	U009	28
GB010039	GEAR:AIO:DRIVE:MIDDLE	U009	29
GB010040	GEAR:AIO:DRIVE:1	U009	30
GB011101	GEAR - 37Z	U009	31
GB011102	GEAR - 19/38Z	U009	32
GB011103	GEAR - 28/36Z	U009	33
GB011104	GEAR - 20/35Z	U009	34
GB011105	GEAR - 29Z	U009	35
GB011106	GEAR - 22/31Z	U009	36
GB011108	GEAR - 21Z	U009	37
GB011109	GEAR - 28Z	U009	38
GB011110	GEAR - 31Z	U009	39
GB011111	GEAR - 19Z	U009	40
GB011112	GEAR - 29Z	U009	41
GB011118	REGIST DRIVE GEAR	U009	42
GB011133	GEAR - 15Z	U006_S001	20
		U008_S001	14
GB012102	GEAR - 54Z	U009	43
GB013114	GEAR - 35Z	U009	44
GB013115	GEAR - 21Z	U009	45
GB013117	GEAR - 19Z	U009	46
GB017103	GEAR - 21/45Z	U009	47
GB017104	GEAR - 24/57Z	U009	48
GB017109	GEAR - 16/42Z	U009	49
GB017111	GEAR - 16/51Z	U009	50
GB017112	GEAR - 21/73Z	U009	51
GB017113	GEAR - 40/65Z	U009	52
GB017116	GEAR - 17/42Z	U009	53
GB017120	GEAR:AIO:JOINT:2	U009	54
GB017123	GEAR:AIO:DRIVE	U009	55
GB017124	GEAR:TRANSFER:DRIVE:MIDDLE	U009	56
GB030036	PULLEY - 18T	U009	57
GF020000	REGISTRATION ROLLER - DRIVE	U006_S001	21
GF020060	TRANSPORT ROLLER:DUPLEX	U006_S001	22

Exclusive Parts

Number	Part Name	Group	ID
GF020061	EXIT ROLLER	U008_S001	15
GX041120	STEPPER MOTOR - DC 14.8W	U009	58
GX061148	BRUSHLESS MOTOR:DC24V:10W	U009	59
GX061149	BRUSHLESS MOTOR:DC24V:21W	U009	60
GX061150	BRUSHLESS MOTOR:DC24V:35W	U009	61
GX201123	MAGNETIC CLUTCH:0.25N	U004	29
		U009	62
GX450006	HEATER:110V:1000W	U007_S001	7
		U007_S002	7
GX450009	HEATER:230V:1000W	U007_S001	8
		U007_S002	8
GZ230061	POWER SUPPLY UNIT:NA/TWN:139W	U010	53
GZ230062	POWER SUPPLY UNIT:EU/AA/CHN:139W	U010	54
GZ300004	POWER PACK	U010	55
H5213355	C RING - PAPER FEED ROLLER	U004	30
J0121515	LOGO PLATE - NSA	ACCESSORIES	6
		DECALS AND DOCUMENTS	12
J0121516	LOGO PLATE - REX	ACCESSORIES	7
		DECALS AND DOCUMENTS	13
J0121517	LOGO PLATE - GES	ACCESSORIES	8
		DECALS AND DOCUMENTS	14
M0182562	BASE:ADHESION	U004_S001_S001	31
M0182608	COVER:BASE	U004_S001	32
M0184459	ROLLER:DRIVEN:EXIT:OUTER	U008_S001	16
M0184464	GUIDE:PLATE:EXIT:OUTER	U008_S001	17
M0352620	FRICTION PAD	U004_S001	33
M0353974	COMPRESSION SPRING:HOUSING:TRANSPORT	U001	45
M0751105	BRACKET:MOTOR	U009	63
M0751107	SHIELDING PLATE:GEAR:2	U009	64
M0751251	GUIDE:LOUVER	U001_S001	46
M0751252	SEAL:STOPPER:LOUVER	U001_S001	47
M0751253	LOUVER	U001_S001	48

Number	Part Name	Group	ID
M0751308	SEAL:GUIDE:LOUVER:UPPER	U001_S001	49
M0751309	SEAL:GUIDE:LOUVER:LOWER	U001_S001	50
M0754607	SPRING:PRESSURE:DUPLEX	U001	51
M0931851	IMAGING UNIT:ASS'Y	U003_S001	2
M0951381	DECAL:NAME PLATE:M095:RICOH	ACCESSORIES	9
M0951400	OPERATION PANEL:M095:EU: ASS'Y	U002_S002	2
M0951403	OPERATION PANEL:M095:TWN:ASS'Y	U002_S003	3
M0955652	PCB:CTL:PGDI:ASS'Y for M095	U010	56
M0960042	COVER:LEFT:ASS'Y	U001_S001	52
M0961277	COVER:PAPER EXIT SUB-UNIT	U001	53
M0961304	COVER:REAR:EU	U001	54
M0961381	DECAL:NAME PLATE:M096:RICOH	DECALS AND DOCUMENTS	15
M0961384	DECAL:NAME PLATE:M096:NAS	ACCESSORIES	10
		DECALS AND DOCUMENTS	16
M0961385	DECAL:NAME PLATE:M096:REX	ACCESSORIES	11
		DECALS AND DOCUMENTS	17
M0961386	DECAL:NAME PLATE:M096:GES	ACCESSORIES	12
		DECALS AND DOCUMENTS	18
M0961400	OPERATION PANEL:M096:EU:ASS'Y	U002_S001	4
M0961466	PCB:PERSEUS-P2:OPU	U002_S001	5
		U002_S002	5
		U002_S003	5
M0962550	PAPER TRAY:ASS'Y	U004_S001	35
M0962560	SIDE FENCE:LEFT:MANUAL FEED	U004_S001	36
M0962561	SIDE FENCE:RIGHT:MANUAL FEED	U004_S001	37
M0963800	HOUSING:TRANSPORT SUB-UNIT:ASS'Y	U006_S001	25
M0963902	COVER:FRONT	U001	55
M0963912	HOLDER:GUIDE PLATE:REVERSE	U001	56
M0963923	GUIDE PLATE:EXIT:MIDDLE	U001	57

Exclusive Parts

Number	Part Name	Group	ID
M0963924	FEELER:PAPER FEED SENSOR	U001	58
M0963926	ROLLER:GUIDE:EXIT:MIDDLE	U001	59
M0963987	Decal:Grip:Housing	DECALS AND DOCUMENTS	19
		U006_S001	26
M0963988	Decal:Insert Sub-unit:Transport Unit	DECALS AND DOCUMENTS	20
		U006_S001	27
M0963989	RESISTOR:TRANSFER/SEPARATION	U006_S001	28
M0963993	RESISTOR:EARTH:PAPER FEED	U011	72
M0963994	RESISTOR:EARTH:EXIT:DISCHARGE SECTION	U008_S001	18
M0964019	FUSING UNIT - TWN 110V	U007_S002	17
M0964027	FUSING UNIT - 230V	U007_S001	18
M0964076	FUSING ENTRANCE GUIDE PLATE:UPPER	U007_S001	19
		U007_S002	19
M0964077	FUSING ENTRANCE GUIDE PLATE:LOWER	U007_S001	20
		U007_S002	20
M0964084	HOLDER:FUSING ENTRANCE GUIDE PLATE:RIGHT	U007_S001	9
		U007_S002	9
M0964085	HOLDER:FUSING ENTRANCE GUIDE PLATE:LEFT	U007_S001	10
		U007_S002	10
M0964089	TORSION SPRING:FUSING ENTRANCE GUIDE PLATE:RIGHT	U007_S001	11
		U007_S002	11
M0964090	TORSION SPRING:FUSING ENTRANCE GUIDE PLATE	U007_S001	12
		U007_S002	12
M0964111	COVER:FUSING	U007_S001	21
		U007_S002	21
M0964112	PRESSURE COVER	U007_S001	13
		U007_S002	13
M0964114	GUIDE PLATE:EXIT:PRESSURE	U007_S001	14
		U007_S002	14
M0964115	TORSION SPRING:GUIDE PLATE:PRESSURE:RIGHT	U007_S001	15
		U007_S002	15
M0964116	TORSION SPRING:GUIDE PLATE:PRESSURE:LEFT	U007_S001	16
		U007_S002	16
M0964117	DECAL:FUSING EXIT:OPEN AND C	DECALS AND DO	21

Number	Part Name	Group	ID
	LOSE	CUMENTS	
		U007_S001	22
		U007_S002	22
M0964126	DECAL:FUSING:LEVER:LEFT	DECALS AND DOCUMENTS	22
		U007_S001	23
		U007_S002	23
M0964127	DECAL:FUSING:LEVER:RIGHT	DECALS AND DOCUMENTS	23
		U007_S001	24
		U007_S002	24
M0964128	DECAL:CAUTION:FUSING PRESSURE RELEASE	ACCESSORIES	13
		DECALS AND DOCUMENTS	24
M0964450	GUIDE:EXIT:ASS'Y	U008_S001	19
M0964455	GROUND PLATE:EXIT:1	U008_S001	20
M0964456	GROUND PLATE:EXIT:2	U008_S001	21
M0964458	SPRING:PRESSURE:EXIT:INNER	U008_S001	22
M0964459	FEELER:L	U008_S001	23
M0964460	SPRING:PRESSURE:EXIT:OUTER	U008_S001	24
M0964461	FEELER:R	U008_S001	25
M0964462	LINK:SLIDE	U008_S001	26
M0964463	LINK:TURN	U008_S001	27
M0964464	COMPRESSION SPRING	U008_S001	28
M0964465	TORSION SPRING:1	U008_S001	29
M0964466	TORSION SPRING:2	U008_S001	30
M0965126	PCB:EGB:ASS'Y	U010	57
M0965652	PCB:CTL:PPCL:ASS'Y	U010	58
M0965703	DC SOLENOID:FUSING:ASS'Y	U011	73
M0965711	SHADEING PLATE:HARNESS:POWER SUPPLY UNIT	U010	59
M0965760	GROUND PLATE:REGISTRATION ROLLER	U011	74
M0965761	GROUND PLATE:BASE:PSU	U011	75
M0966000	INTERMEDIATE TRANSFER SECTION:ASS'Y	U005_S001	9
M0966202	TRANSFER ROLLER:SUB-ASS'Y	U006_S001_S001	29
M0976250	TRANSFER ROLLER:TRANSFER/S	U006_S001_S001	24

Exclusive Parts

Number	Part Name	Group	ID
	EPARATION		
M1981085	SPRING PLATE:LSU:POSITIONING	U011	76
M1982580	SHAFT:PAPER FEED ROLLER:PRE SS FIT	U004	38

Standard Parts



03530030N
SCREW:M3X3



03530040N
SCREW - M3X4



03530060N
BIND SCREW - M3X6



03603006N
SCREW - M3X6



03603010N
SCREW:M3X10



04503010N
TAPPING SCREW - M3X10



04503016N
TAPPING SCREW:3X16



04504010N
TAPPING SCREW:M4X10



04524010N
BINDING SELF-TAPPING SCR
EW:4X10



04543006Q
TAPPING SCREW - M3X6



04543008Q
TAPPING SCREW:3X8



07200030E
RETAINING RING - M3



07200040E
RETAINING RING - M4



07200060E
RETAINING RING - M6



09543008N
SCREW - M3X8



11024473
CT CONNECTOR - 2P



11024559
CONNECTOR - 3P

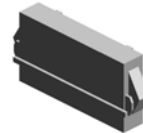

11029156
CONNECTOR



11033902
CONNECTOR - 10P



11050487
HARNES CLAMP



11050508
HARNES CLAMP - LWS-071
1



11050516
CLAMP



11050518
EDGE SADDLE - LES-1010



11050724
CLAMPS:WES-1210



11500409
(-19):POWER SUPPLY CORD
-125V 15A TWN



11500457
POWER SUPPLY CODE:250V:
10A:EU



12042612
MICRO SWITCH:D3V-16506-3
C25

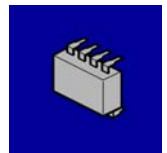

14075317
EEPROM:M24C16-WBN6(REV
.S/W/G)

Design Change List

Number	Title	Set	Old Part		New Part		Index No.		Q'ty	Interchg		Reason	Cut-in S/N
			P/N	Name	P/N	Name	Group	ID		Indiv.	Set		
201504-01	1504 Modification	-	11050518	EDGE SADDLE - LES-1010	11050724	CLAMPS:WES-12	U010	12	1	O/O			M095-19_22_27: M09622-27:
201401-01	1401 Modification	-			M0976250	TRANSFER ROLLER:TRANSFER/SEPARATION	U006_S001_S001	24	1				M095-19_22_27: M09622-27:
201308-01	1308 Modification	A	G1662580	SHAFT - PAPER FEED ROLLER	M1982580	SHAFT:PAPER FEED ROLLER:PRESS FIT	U004	38	1	X/X	X/O		M095-19_22_27: M09622-27:
201308-02	1308 Modification	A	8050089	RETAINING RING - M4	H5213355	C RING - PAPER FEED ROLLER	U004	30	1	X/X	X/O		M095-19_22_27: M09622-27:
201309-01	1309 Modification	-	M0966200	TRANSFER ROLLER:SUB-ASS'Y	M0966202	TRANSFER ROLLER:SUB-ASS'Y	U006_S001_S001	29	1	O/O			M095-19_22_27: M09622-27:
201309-02	1309 Modification	-	G1661085	SPRING PLATE:LSU:POSITIONING	M1981085	SPRING PLATE:LSU:POSITIONING	U011	76	1	X/O			M095-19_22_27: M09622-27:
201301-01	1301 Modification	-			M0964084	HOLDER:FUSING ENTRANCE GUIDE PLATE:RIGHT	U007_S002	9	1				M095-19_22_27: M09622-27:
					M0964084	HOLDER:FUSING ENTRANCE GUIDE PLATE:RIGHT	U007_S001	9	1				
201301-02	1301 Modification	-			M0964085	HOLDER:FUSING ENTRANCE GUIDE PLATE:LEFT	U007_S002	10	1				M095-19_22_27: M09622-27:
					M0964085	HOLDER:FUSING ENTRANCE GUIDE PLATE:LEFT	U007_S001	10	1				
201212-01	1212 Modification	-			M0964112	PRESSURE COVER	U007_S001	13	1				M095-19_22_27: M09622-27:
							U007_S002	13	1				
201201-01	1201 Modification	-			M0964089	TORSION SPRING:FUSING ENTR	U007_S001	11	1				M095-19_22_27: M09622-27:
							U007_S002	11	1				

Design Change List

Number	Title	Set	Old Part		New Part		Index No.		Q'ty	Interchg		Reason	Cut-in S/N
			P/N	Name	P/N	Name	Group	ID		Indiv.	Set		
		-				ANCE GUIDE PL ATE:RIGHT							
201201-02	1201 Modification	-			M0964090	TORSION SPRIN G:FUSING ENTR ANCE GUIDE PL ATE	U007_S001	12	1				M095-19_22_27: M09622-27:
							U007_S002	12	1				
201201-03	1201 Modification	-			M0964114	GUIDE PLATE:EX IT:PRESSURE	U007_S001	14	1				M095-19_22_27: M09622-27:
							U007_S002	14	1				
201201-04	1201 Modification	-			M0964115	TORSION SPRIN G:GUIDE PLATE: PRESSURE:RIGH T	U007_S001	15	1				M095-19_22_27: M09622-27:
							U007_S002	15	1				
201201-05	1201 Modification	-			M0964116	TORSION SPRIN G:GUIDE PLATE: PRESSURE:LEFT	U007_S001	16	1				M095-19_22_27: M09622-27:
							U007_S002	16	1				
201207-01	1207 Modification	-	GZ300003	POWER PACK	GZ300004	POWER PACK	U010	55	1	O/O			M095-19_22_27: M09622-27:
201411-01	1411 Modification	-	G1665430	POWER SUPPLY CORD -250V 10A EU	11500457	POWER SUPPLY CODE:250V:10A: EU	ACCESSO RIES	2	1	O/O			M095-19_22_27: M09622-27:

