

Epson Document Capture Pro

DATASHEET

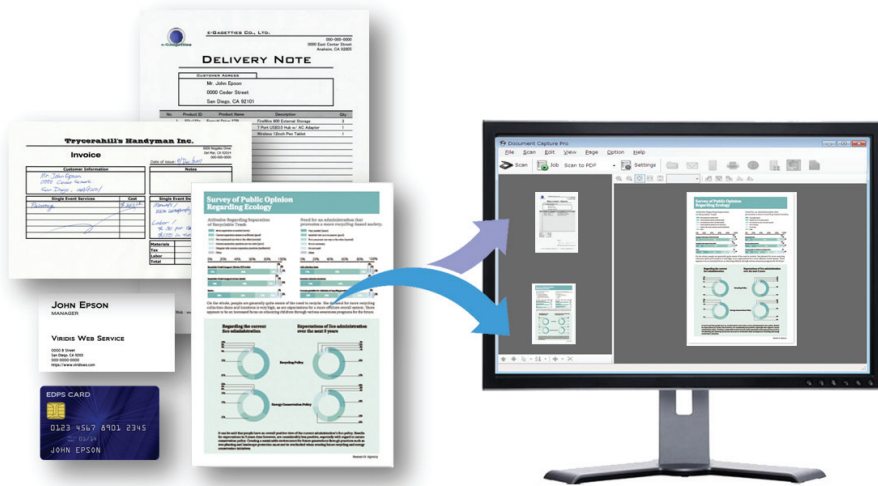

Businesses of all sizes are finding now, more than ever before, that Document Management Systems (DMS) are the best way to integrate paper documents into their workflow. To help boost businesses' productivity, Epson is offering its own software package for free download from its website.

Document Capture Pro is compatible with all common Document Management Systems and cloud storage repositories, opening up a world of possibilities for businesses who need to digitise paper documents.

It can be used in a number of different ways with Epson's business scanners: with the Workforce DS-30 mobile scanner for handling sales enquiries, contracts or order forms in the field or on customers' sites, or with the GT-S55 and GT-S85 high-performance scanners for fast management of multiple pages and large batches of paper.

Users don't need any special training to get started, as Document Capture Pro has an intuitive interface which is quick to master. For ease-of-use it also has advanced document imaging features and supports all common file formats, including BMP, JPEG, TIFF, PDF, searchable PDF and PDF/A.

The versatile Document Capture Pro suits everyone from the beginner to the advanced user. Do more than just scan with it, as it offers many 'scan-to' functions, including scan-to-cloud, scan-to-FTP and scan-to-SharePoint alongside the ability to handle batch separation, barcode recognition and zonal OCR-A and OCR-B support. And, as Epson offers its partners a Self Developer Kit, users can benefit from their ability to add plug-ins to DMS or cloud services to suit almost any business.

KEY FEATURES

- Boost productivity at no extra cost
- Seamlessly integrates into almost all Document Management Systems and cloud services
- Compatible with Epson business scanners DS-30, GT-S55 and GT-S85
- Intuitive user interface
- Jobs Profiles registration

For free download, please visit:
www.epson.eu/documentcapturepro

EPSON[®]
EXCEED YOUR VISION

PRODUCT SPECIFICATIONS

COMPATIBILITY	
Models	Workforce DS-30, GT-S55 & GT-S85 Series
Driver	EpsonScan Twain driver
OS	Windows XP 32-bit, Windows XP 64-bit, Windows Vista 32-bit, Windows Vista 64-bit, Windows 7 64-bit, Windows 7 32-bit
USER INTERFACE	
Languages	English / French / German / Italian / Spanish / Portuguese / Russian / Polish / Hungarian Romanian / Czech
Display	Simplified & Advanced modes with customizable toolbar
DOCUMENT IMAGING	
Supported file formats	PDF, Searchable PDF, PDF/A, JPEG, BMP, TIFF, Multi-TIFF
Barcode (1D & 2D) support	UCP/EAN/JAN, ITF, CODE39, CODEBAR, CODE128, QR & PDF147
Scanning mode	B/W, Greyscale, Colour
High Compression PDF	YES
Password protected PDF	YES
BW TIFF compression	CCIT Group4
Color /Greyscale TIFF Compression	LZW, JPEG(7)
IMAGE PROCESSING	
Basic	Auto-de-skew Auto-rotation Auto-colour detection Punch hole removal Undo rotation & de-skew Advanced sorting features (date, colour, type) Manual document separation Zoom
Advanced	Horizontal and vertical split documents Skip blank page Multi-stream (GT-S55/85 Series only) Append/delete/replace pages Addition of pages from file* or scanner
OUTPUT	
Job separation	Automatic job separation from barcode, Zonal OCR A & B, blank page, fixed page
Folder creation	Automatic folder creation from barcode, Zonal OCR A & B, date & time, pre-defined prefix
File naming	Automatic file creation from barcode, Zonal OCR A & B, pre-defined prefix, date & time
EXPORT FUNCTIONS	
	Email connector (MAPI, SMTP support) Local & network folder connector FTP connector Webfolder connector Print connector to Epson printers
DMS & Cloud connectors	GoogleDocs connector Evernote connector SharePoint connector
Other capabilities	Export / import job list Jobs log file Watched folders

* PDF addition is limited to scanned files



For further information please contact your local Epson office or visit www.epson-europe.com

Austria 0810/20 01 13 (0,07 €/Min.) **Belgium** 070/350120 (0.1735 €/min.) **Czech** 800/142 052 **Denmark** 44 50 85 85 **Finland** 0201 552 091
France 09 74 75 04 04 (Cost of local call, operator charges may apply) **Germany** 01805/23 41 10 (0,14 €/Min. aus dem dt. Festnetz, Mobilfunkpreise
abweichend. Ab 1.3.2010 Mobilfunkpreis max. 0,42 €/Min.) **Greece** 210-8099499 **Hungary** 06800 147 83 **Ireland** 01 436 7742 **Italy** 02-660321 10
(0,12 €/min.) **Luxembourg** 900/43010 (0,24 €/min.) **Middle East** +9714 8818934 **Netherlands** 0900-5050808 (0,05 €/oproep + 0,15 €/min.)
Norway +47 67 11 37 00 **Poland** 0-0-800 4911299 (0,16 zł/min.) **Portugal** 707 222 111 **Russia** (095) 777-03-55 **Slovakia** 0850 111 429
South Africa (+2711) 465-9621 **Spain** 93 582 15 00 **Sweden** 0771-400135 (Mobilsamtal – 0,99 kr/min, Lokala samtal – 0,30 kr/min, Utlandssamtal – 0,89 kr/min)
Switzerland 0848 448820 (4-8 cent./min.) **Turkey** (0212) 3360303 **United Kingdom** 0871 222 6702

Trademarks and registered trademarks are the property of Seiko Epson Corporation or their respective owners.
Product information is subject to change without prior notice.

EPSON®