

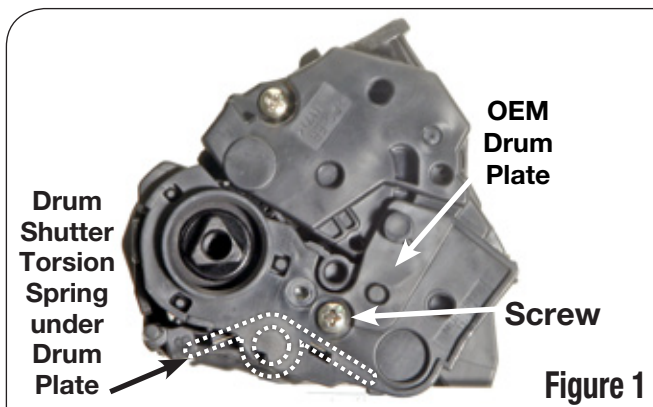

Note: Refer to SSS™ #967 for full cartridge remanufacturing instructions.

Converting an HP® CB435A to an HP® CE285A/CB435A

- Using a Phillips screwdriver, remove the screw from the drum plate (Figure 1).



- Using a hook tool, move the shutter torsion spring into the indent on the drum plate as shown in Figures 1 & 2. Remove the drum plate ensuring that the drum shutter torsion spring does not get lost.

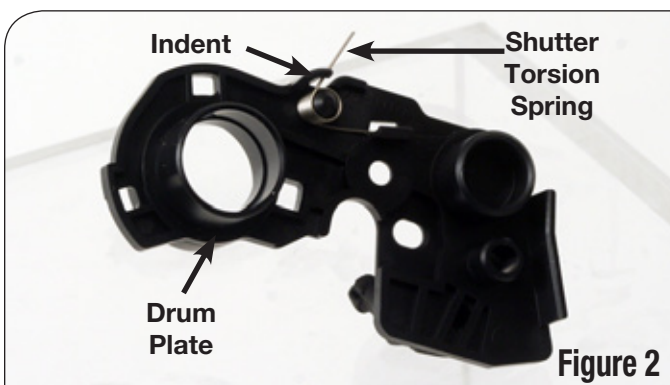

- Position the cartridge with the hopper facing upward and grasping tightly, slide the waste bin section and hopper side apart as shown in Figure 3.

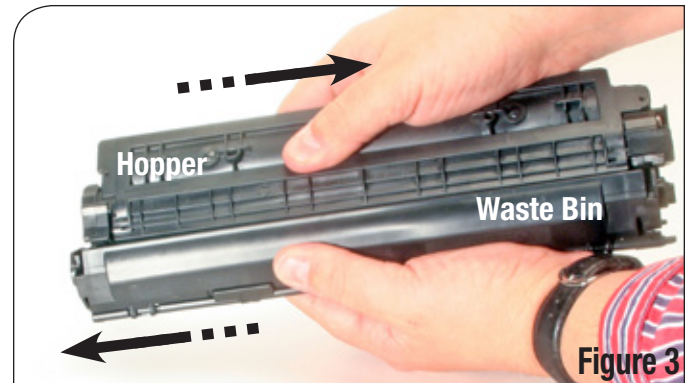

Note: If separated incorrectly, waste toner will spill.

- Remove the OEM gear side end plate by using a Phillips screwdriver to remove the two screws noted in Figure 4.

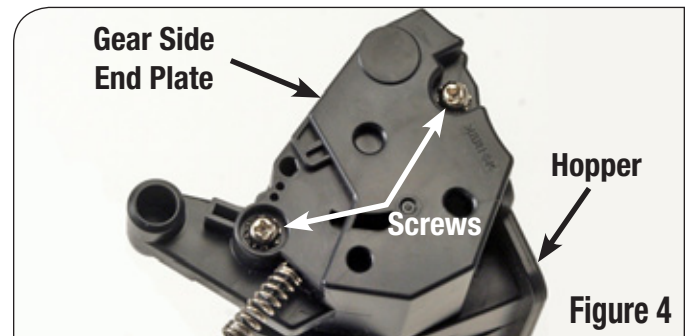

- Cut away an area on the drive side hopper base as noted in Figure 5. The area to be removed is 0.22 in. (5.59mm) wide.

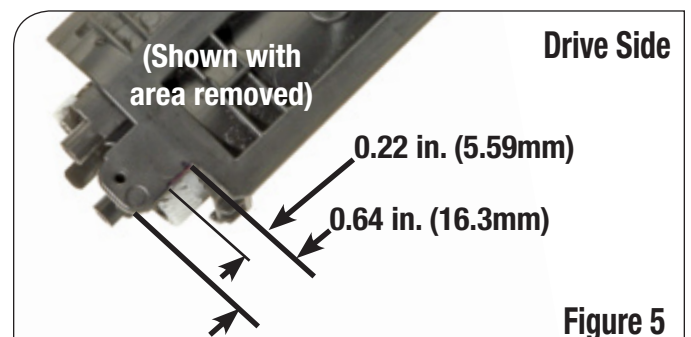

6. Using the new Static Control universal gear side end plate, apply a small amount of LubriPlate 105 lubricant to the mag roller gear recess (Figure 6).

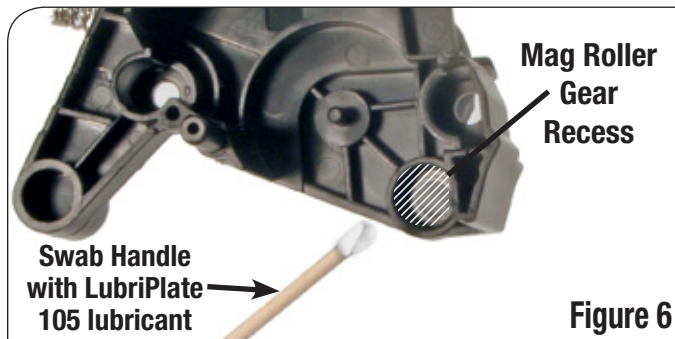

7. Install the new Static Control universal gear side end plate and secure with two Phillips screws (Figure 7).

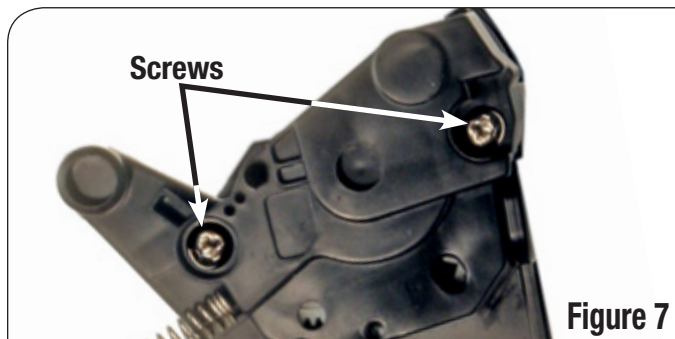

8. Align bosses on the hopper to openings on the waste bin. Carefully slide the toner hopper and waste bin sections together as shown in Figure 8. Verify the springs between the hopper and waste bin are straight.

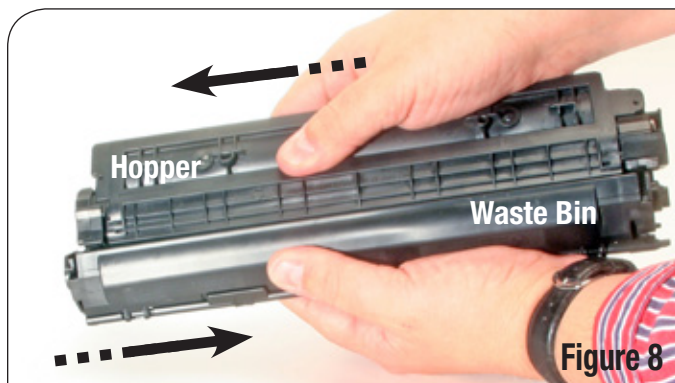

9. With the drum shutter in the closed position, install the drum plate of the cartridge ensuring that the drum shutter torsion spring is in the correct position (Figure 9).

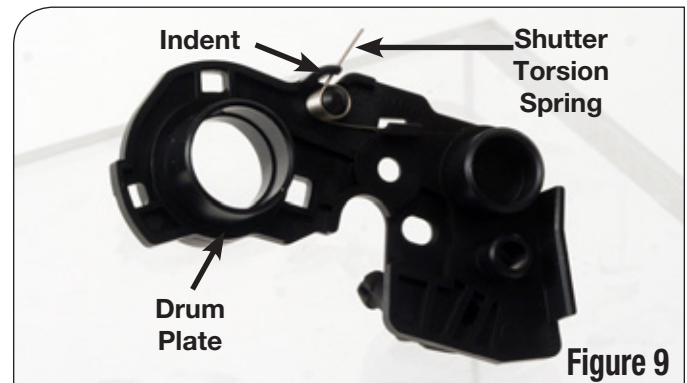

10. Using a Phillips screwdriver, install the screw into the drum plate (Figure 10).

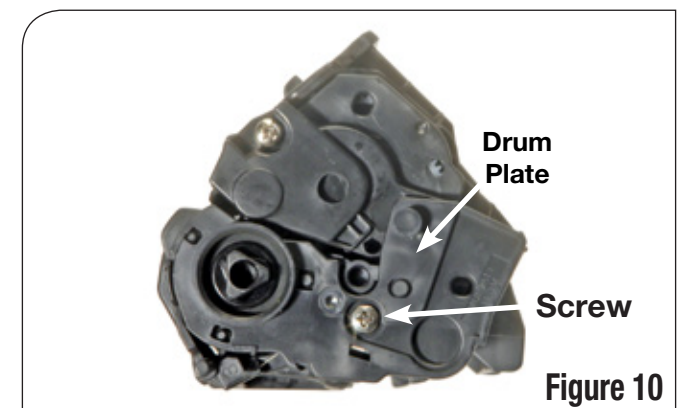

11. Release the shutter torsion spring arm from the indent on the drum plate (Figure 11). Open and close the drum shutter to ensure the spring is engaged.

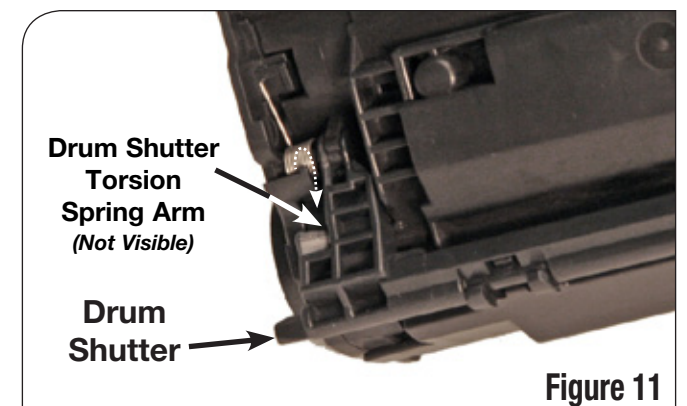

Converting an HP® CB436A to an HP® CE278A/CB436A

12. Using a Phillips screwdriver, remove the screw from the drum plate (Figure 12).

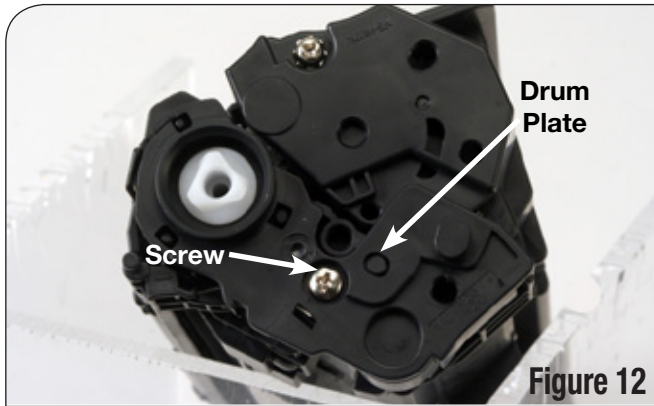

13. Using a hook tool, move the shutter torsion spring into the indent on the drum plate as shown in Figure 13. Then remove the drum plate ensuring that the drum shutter torsion spring does not get lost.

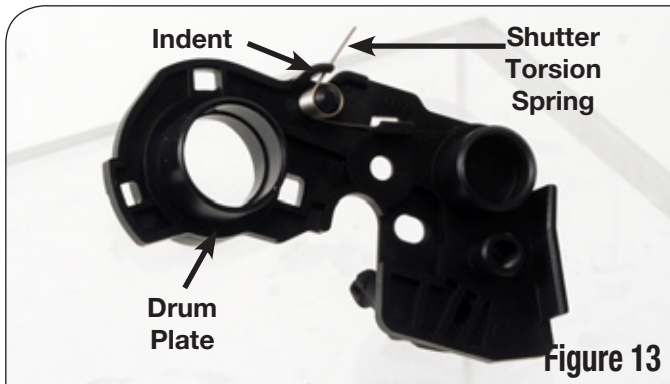

14. Position the cartridge with the hopper facing upward and grasping tightly, slide the waste bin section and hopper side apart as shown in Figure 14.



Note: If separated incorrectly, waste toner will spill.

15. Remove an area on the contact side hopper base as noted in Figure 15. The removed area should be 0.20 in. (5.1mm) by 0.68 in. (17.3mm), leaving about 0.73 in. (18.5mm) as noted.

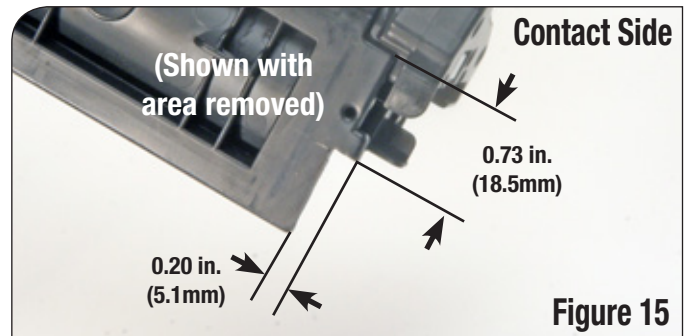

16. Remove the OEM gear side end plate by using a Phillips screwdriver to remove the two screws noted in Figure 16.

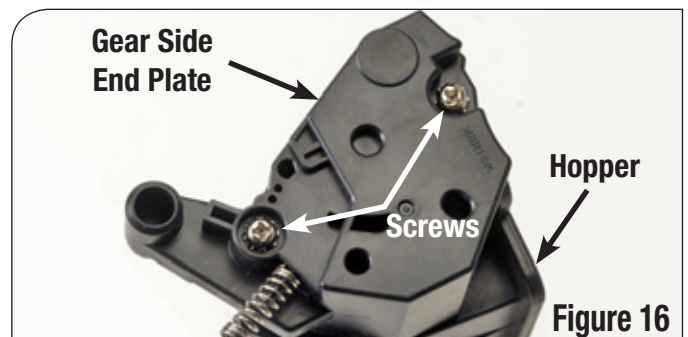

17. Using the new Static Control universal gear side end plate, apply a small amount of LubriPlate 105 lubricant to the mag roller gear recess (Figure 17).

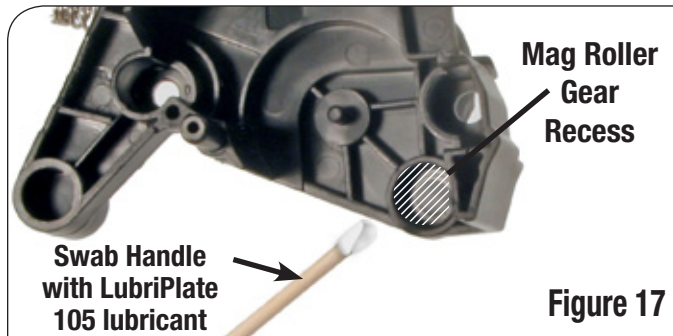

18. Install the new Static Control universal gear side end plate and secure with two Phillips screws (Figure 18).

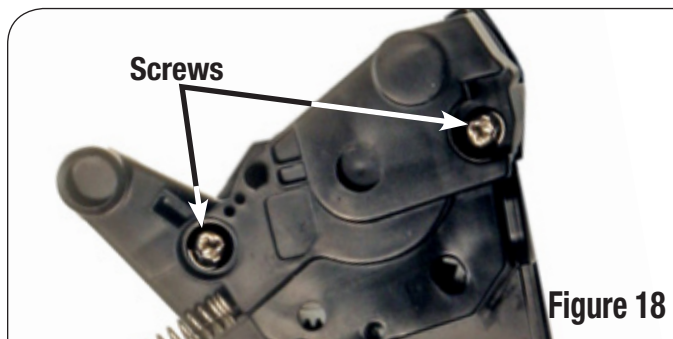

19. Bend the foam/shim along slit (Figure 19a).
20. Using a swab dampened with 91-99% isopropyl alcohol, clean the area noted in Figure 19b.
21. Remove the paper liner covering the adhesive backing from the foam/shim (Figure 19a). Align the edge of the foam/shim to the square protrusion (area noted in Figure 19b) and affix it to the waste bin (Figure 19c, 19d).

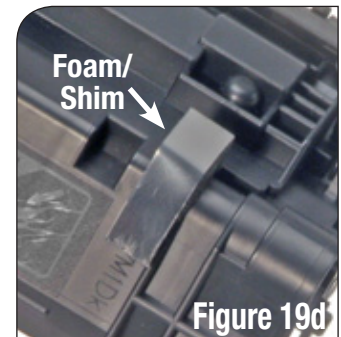
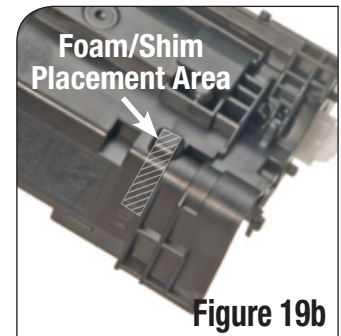
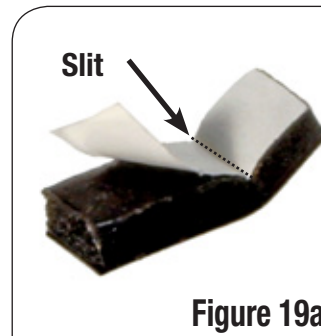

22. Align bosses on the hopper to openings on the waste bin. Carefully slide the toner hopper and waste bin sections together as shown in Figure 20. Verify the springs between the hopper and waste bin are straight.



23. With the drum shutter in the closed position, install the drum plate of the cartridge ensuring that the drum shutter torsion spring is in the correct position as shown in Figure 21.

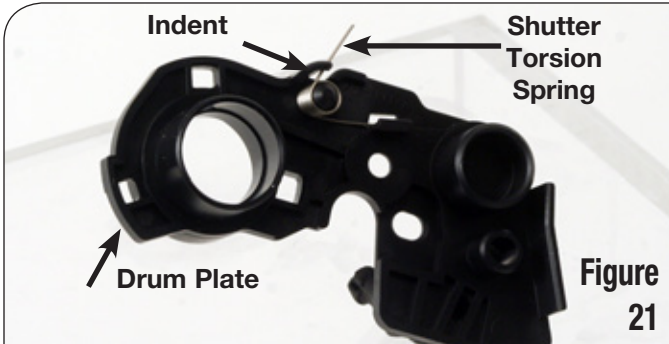

24. Using a Phillips screwdriver, install the screw into the drum plate (Figure 22).

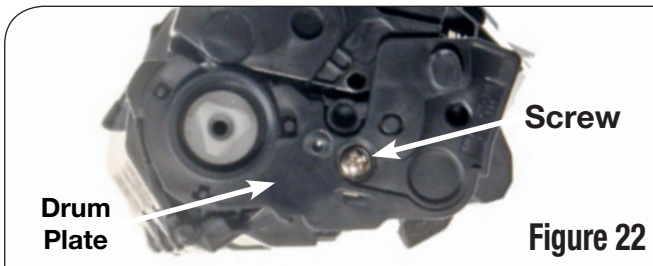

25. Release the shutter torsion spring arm from the indent on the drum plate (Figure 23). Open and close the drum shutter to ensure the spring is engaged.

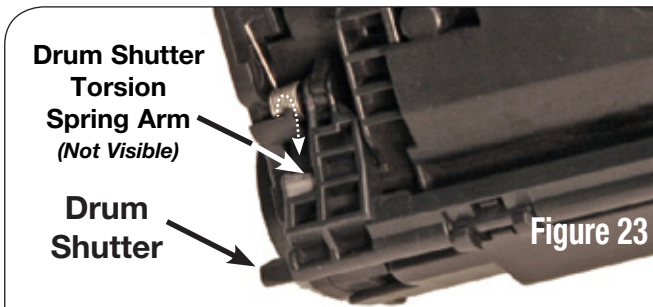

Converting an HP® CB435A or CB436A to an HP® CE278A/CE285A/CB435A/CB436A



Note: HP® CB436A cartridge used as example.

26. Using a Phillips screwdriver, remove the screw from the drum plate (Figure 24).

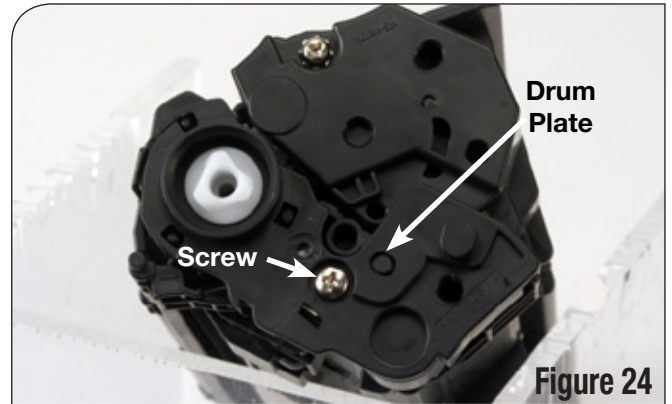

27. Using a hook tool, move the shutter torsion spring into the indent on the drum plate as shown in Figure 25. Then, remove the drum plate and save the drum shutter torsion spring for future use.

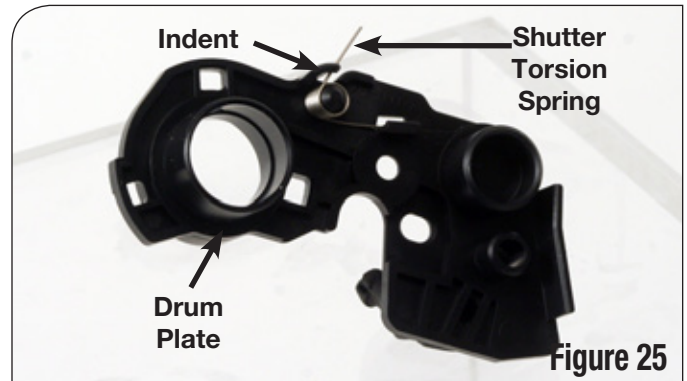

28. Position the cartridge with the hopper facing upward and grasping tightly, slide the waste bin section and hopper side apart, as shown in Figure 26.

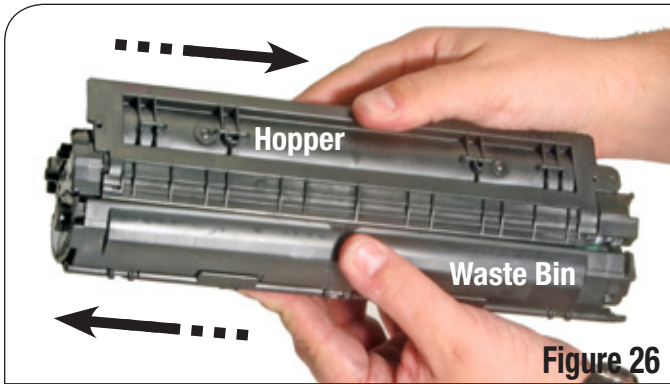

 **Note:** If separated incorrectly, waste toner will spill.

29. Remove the OEM gear side end plate by using a Phillips screwdriver to remove the two screws noted in Figure 27.

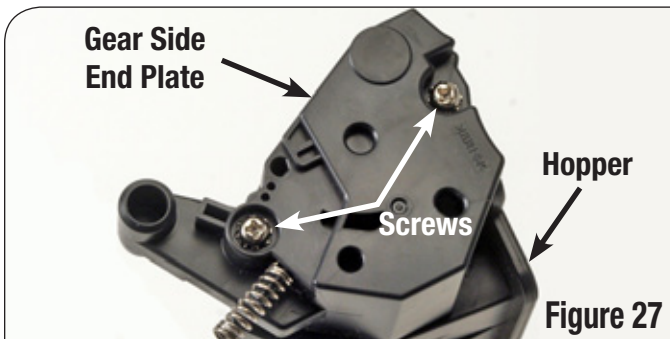

30. For the CB436A, remove an area 0.20 in. (5.1mm) by 0.73 in. (18.5mm). For the CB435A, remove an area 0.20 in. (5.1mm) by 0.60 in. (15.23mm). **Regardless** of the cartridge, the remaining area is 0.73 in. (18.5mm) as measured in Figure 28.

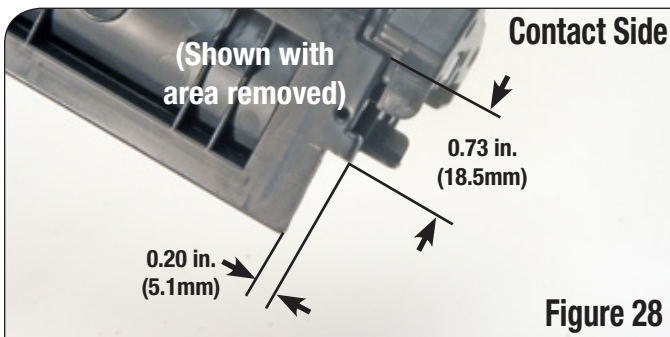

31. On the Gear side of the hopper base, remove an area 0.22 in. (5.59mm) wide (Figure 29).

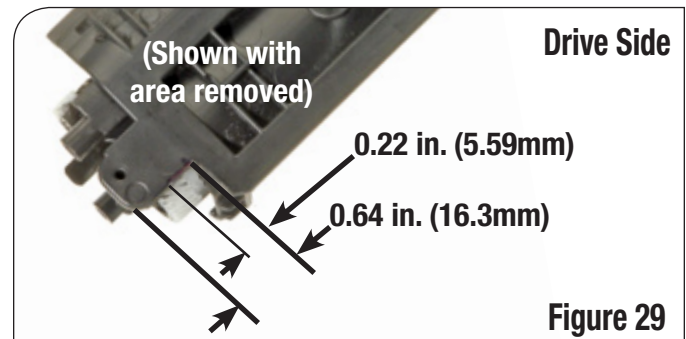

32. Using the new Static Control universal gear side end plate, apply a small amount of LubriPlate 105 lubricant to the mag roller gear recess (Figure 30).

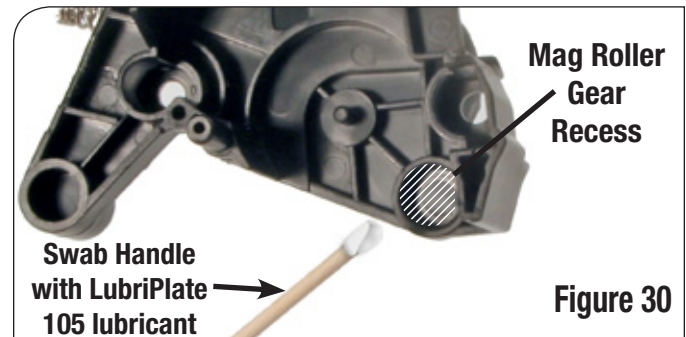

33. Install the new Static Control universal gear side end plate and secure with two Phillips screws (Figure 31).

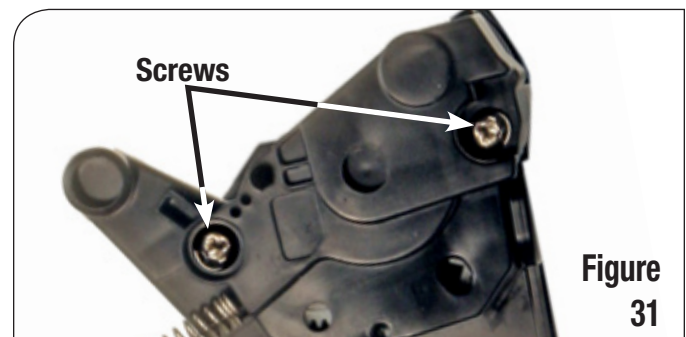

34. Replace the OEM waste bin with the Static Control conversion waste bin (Figure 32).



35. Align bosses on the hopper to openings on the waste bin. Carefully slide the toner hopper and waste bin sections together as shown in Figure 33. Verify the springs between the hopper and waste bin are straight.

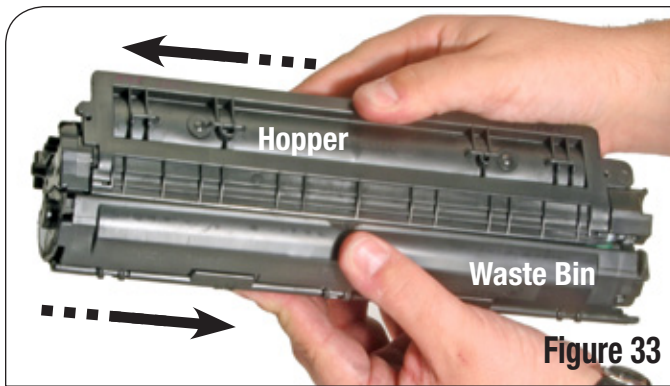

36. With the drum shutter in the closed position, install the new Static Control universal drum plate with OEM drum shutter torsion spring ensuring that the drum shutter torsion spring is in the correct position (in the post with one arm behind the indentation, the other latched behind the tab) as shown in Figure 34.

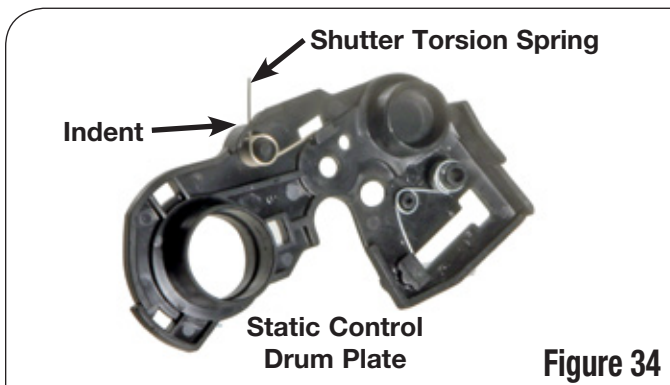

37. Using a Phillips screwdriver, install the screw into the drum plate (Figure 35).

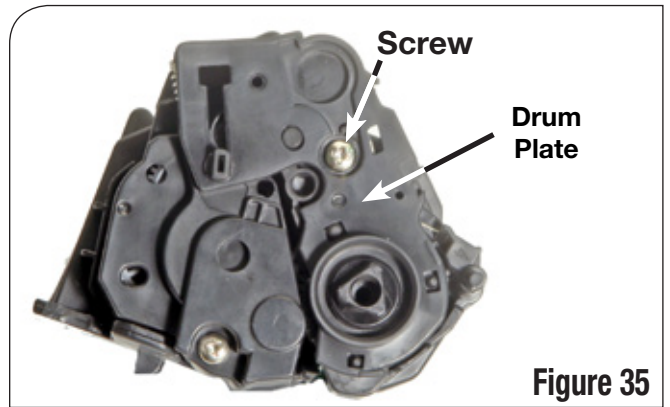

38. Release the shutter torsion spring arm from the indent on the drum plate (Figure 36). Open and close the drum shutter to ensure the spring is engaged.

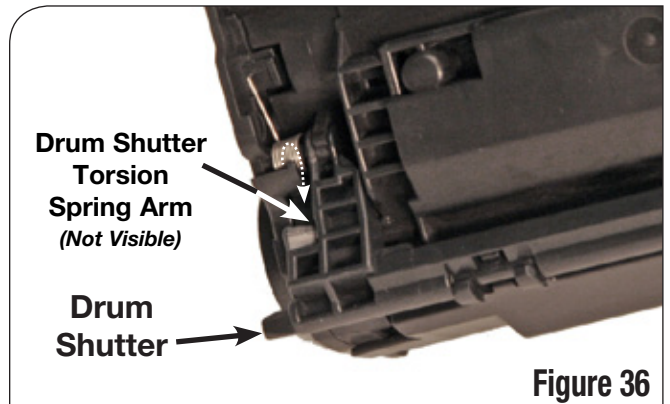

MOVING AT THE SPEED OF NEW TECHNOLOGY

The development of cartridge imaging products and technology is the primary mission of our Imaging Labs. Through extensive testing and research, we develop the optimum combination of matched components for each cartridge. Our engineering and manufacturing expertise provides us with total control in design, quality and development to produce products from the ground up. The results are components that seamlessly work with each other and with good, used OEM parts.

This dedication and commitment results in products that Static Control fully supports, allowing you to quickly attack new market opportunities with complete confidence in the reliability and performance of your cartridges.



Static Control

V.1.1 - 05.11

3010 Lee Avenue PO Box 152 Sanford, NC 27331
US/Can 800-488-2426
US/Can Fax 800-488-2452
Int'l 919-774-3803 Int'l Fax 919-774-1287
www.scc-inc.com

Static Control Components (Europe) Limited
Unit 30, Worton Grange
Reading Berkshire RG2 0TG United Kingdom
Tel +44 (0) 118 923 8030 Fax +44 (0) 118 923 8811
www.scceurope.co.uk